

Site Address of annexed property:

1430 Rosemont Road, West Linn, OR 97068

**RESOLUTION NO. 2014-17  
WEST LINN, OREGON**

**A RESOLUTION OF THE WEST LINN CITY COUNCIL CERTIFYING THE RESULTS OF THE NOVEMBER 4, 2014, GENERAL ELECTION**

**WHEREAS**, at the General Election held on November 4, 2014, in and for the City of West Linn, Clackamas County, Oregon, Measure 3-458 Annexation of 2.126 acres into the City of West Linn; Measure 3-459 Annexation of 2.95 acres into the City of West Linn; Measure 3-460 Annexation of 4.9 acres into the City of West Linn; Measure 3-461 Northern perimeter of Wilderness Park for pedestrian and bike access; the Candidates for Municipal Judge; and the Candidates for City Council were submitted to the voters; and

**WHEREAS**, the election was conducted by mail in ballot by the Clackamas County Elections Department, which established polling places, precincts, and election boards for the election; and

**WHEREAS**, the precincts for said election constituted all of the territory included within the corporate limits of the City of West Linn; and

**WHEREAS**, the City is required to certify the attached election results and do hereby declare the following to be the total from the abstracts of the votes on the City of West Linn ballot for the November 4, 2014, General Election from Clackamas County:

	<b>Yes</b>	<b>No</b>	<b>Total Votes</b>
For Measure 3-458:	7,877	3,274	11,151
For Measure 3-459:	7,741	3,386	11,127
For Measure 3-460:	7,532	3,552	11,084
For Measure 3-461:	9,308	2,233	11,541

For Municipal Judge:	<b>Rhett Bernstein</b>	<b>Write-Ins</b>	<b>Total Votes</b>
	6,465	159	6,624

For Council:

<b>Russel Axelrod</b>	<b>Jody Carson</b>	<b>Mike Jones</b>	<b>Brenda Perry</b>	<b>Write-Ins</b>	<b>Total Votes</b>
5,613	3,232	3,600	5,348	67	17,860

**NOW, THEREFORE, THE CITY OF WEST LINN CERTIFIES AS FOLLOWS:**

**SECTION 1:** The abstract of votes certified by the Office of the Clackamas County Clerk are attached hereto.

**SECTION 2:** Ballot Measures 3-458 Annexation of 2.126 acres into the City of West Linn; Measure 3-459 Annexation of 2.95 acres into the City of West Linn; Measure 3-460 Annexation of 4.9 acres into the City of West Linn; Measure 3-461 Northern perimeter of Wilderness Park for pedestrian and bike access were all approved.

**SECTION 3:** Rhett Bernstein was re-elected as Municipal Judge for the term January 1, 2015, through December 31, 2018.

**SECTION 4:** Russell Axelrod and Brenda Perry were elected as City Councilors for the term January 1, 2015, through December 31, 2018.

This resolution was PASSED and ADOPTED this 8th day of DECEMBER 2014, and takes effect upon passage.

  
JOHN KOVASH, MAYOR

ATTEST:

  
KATHY MOLLUSKY, CITY RECORDER

APPROVED AS TO FORM:

  
CITY ATTORNEY

**Canvass Report — Election Voters — Official**  
**Clackamas County, Oregon — General Election — November 04, 2014**

Page 71 of 141

Total Number of Voters : 161,652 of 229,859 = 70.33

11/24/2014 08:30 AM

Precincts Reporting 118 of 118 = 100.00%

**City of West Linn Municipal Court Judge**

Precinct	Election Ballots Cast	Total Ballots Cast	Registered Voters	Percent Turnout	Rhett L Bernstein	Write-in	Totals
130	1958	1958	2665	73.47%	1016	23	1039
131	2088	2088	2888	72.30%	1117	25	1142
132	1630	1630	2338	69.72%	839	27	866
133	2786	2786	3641	76.52%	1434	30	1464
134	1935	1935	2484	77.90%	952	21	973
135	2063	2063	2676	77.09%	1107	33	1140
<b>Totals</b>	<b>12400</b>	<b>12400</b>	<b>15692</b>		<b>6455</b>	<b>159</b>	<b>6624</b>

CERTIFIED COPY OF THE ORIGINAL  
 SHERRY HALL, COUNTY CLERK

BY:

*Sherry Hall*

**Canvass Report — Election Voters — Official**  
**Clackamas County, Oregon — General Election — November 04, 2014**

Page 72 of 141

11/24/2014 08:30 AM

Total Number of Voters : 161,652 of 229,859 = 70.33

Precincts Reporting 118 of 118 = 100.00%

**City of West Linn City Councilor (2 seats)**

Precinct	Election Ballots Cast	Total Ballots Cast	Registered Voters	Percent Turnout	Jody Carson	Brenda M Perry	Mike Jones	Russell B Axelrod	Uncertified	Totals
130	1958	1958	2665	73.47%	510	841	547	848	9	2755
131	2088	2088	2888	72.30%	662	749	662	808	12	2893
132	1630	1630	2338	69.72%	420	661	510	662	10	2263
133	2786	2786	3641	76.52%	732	1190	841	1270	24	4057
134	1935	1935	2484	77.90%	415	999	426	1058	8	2906
135	2063	2063	2676	77.09%	493	908	614	967	4	2986
<b>Totals</b>	<b>12460</b>	<b>12460</b>	<b>16882</b>		<b>3232</b>	<b>5348</b>	<b>3800</b>	<b>5813</b>	<b>67</b>	<b>17860</b>

CERTIFIED COPY OF THE ORIGINAL  
 SHERRY HALL, COUNTY CLERK

BY: \_\_\_\_\_

*Sherry Hall*

**Canvass Report — Election Voters — Official**  
**Clackamas County, Oregon — General Election — November 04, 2014**

Total Number of Voters : 161,652 of 229,859 = 70.33

Page 124 of 141

11/24/2014 08:30 AM

Precincts Reporting 118 of 118 = 100.00%

**Measure 3-458 Annexation of 2.126 acres into the City of West Linn**

Precinct	Election Ballots Cast	Total Ballots Cast	Registered Voters	Percent Turnout	YES	NO	Totals
130	1958	1958	2665	73.47%	1242	505	1747
131	2088	2088	2888	72.30%	1348	535	1883
132	1630	1630	2338	69.72%	977	483	1460
133	2786	2786	3641	76.52%	1811	695	2506
134	1935	1935	2484	77.90%	1228	480	1708
135	2063	2063	2676	77.09%	1271	576	1847
<b>Totals</b>	<b>12480</b>	<b>12480</b>	<b>16892</b>		<b>7877</b>	<b>3274</b>	<b>11151</b>

CERTIFIED COPY OF THE ORIGINAL  
 SHERRY BULL COUNTY CLERK

BY:

*Sherry Bull*

**Canvass Report — Election Voters — Official**  
**Clackamas County, Oregon — General Election — November 04, 2014**

Page 125 of 141

11/24/2014 08:30 AM

Total Number of Voters : 161,652 of 229,859 = 70.33

Precincts Reporting 118 of 118 = 100.00%

**Measure 3-459 Annexation of 2.95 acres into the City of West Linn**

Precinct	Election Ballots Cast	Total Ballots Cast	Registered Voters	Percent Turnout	YES	NO	Totals
130	1958	1958	2665	73.47%	1251	494	1745
131	2088	2088	2888	72.30%	1341	544	1885
132	1630	1630	2338	69.72%	948	510	1458
133	2786	2786	3641	76.52%	1759	736	2495
134	1935	1935	2484	77.90%	1210	494	1704
135	2063	2063	2676	77.09%	1232	608	1840
<b>Totals</b>	<b>12450</b>	<b>12450</b>	<b>16892</b>		<b>7741</b>	<b>3386</b>	<b>11127</b>

CERTIFIED COPY FOR THE ORIGINAL  
 SHERIFF HALL, COUNTY CLERK

BY: 

**Canvass Report — Election Voters — Official**  
**Clackamas County, Oregon — General Election — November 04, 2014**

Total Number of Voters : 161,652 of 229,859 = 70.33

Page 126 of 141

11/24/2014 08:30 AM

Precincts Reporting 118 of 118 = 100.00%

**Measure 3-460 Annexation of 4.9 acres into the City of West Linn**

Precinct	Election Ballots Cast	Total Ballots Cast	Registered Voters	Percent Turnout	YES	NO	Totals
130	1958	1958	2665	73.47%	1210	533	1743
131	2088	2088	2888	72.30%	1302	574	1876
132	1630	1630	2338	69.72%	932	514	1446
133	2786	2786	3641	76.52%	1720	772	2492
134	1935	1935	2484	77.90%	1183	513	1696
135	2063	2063	2676	77.09%	1185	646	1831
<b>Totals</b>	<b>12480</b>	<b>12480</b>	<b>16692</b>		<b>7632</b>	<b>3552</b>	<b>11084</b>

CERTIFIED COPY OF THE ORIGINAL  
 SHERRY HALL, COUNTY CLERK

BY:

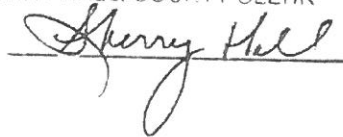



**Canvass Report — Election Voters — Official**  
**Clackamas County, Oregon — General Election — November 04, 2014**

Page 127 of 141

11/24/2014 08:30 AM

Total Number of Voters : 161,652 of 229,859 = 70.33

Precincts Reporting 118 of 118 = 100.00%

**Measure 3-461 Northern perimeter of Wilderness Park for pedestrian and bike access**

Precinct	Election Ballots Cast	Total Ballots Cast	Registered Voters	Percent Turnout	YES	NO	Totals
130	1958	1958	2665	73.47%	1411	381	1792
131	2088	2088	2888	72.30%	1558	380	1938
132	1630	1630	2338	69.72%	1200	319	1519
133	2786	2786	3641	76.52%	2145	485	2610
134	1935	1935	2484	77.90%	1429	341	1770
135	2063	2063	2676	77.09%	1565	347	1912
<b>Totals:</b>	<b>12480</b>	<b>12480</b>	<b>16592</b>		<b>9308</b>	<b>2233</b>	<b>11541</b>

CERTIFIED COPY OF THE ORIGINAL  
SHEPARD COUNTY CLERK

BY: 

$$1'' = 100'$$

**D. L. C.**  
**JULIA ANN LEWIS NO. 54**  
**SAMUEL W. SHANNON NO. 70**

Cancelled 7

30(

31(

33(

33(

34(

21(

33(

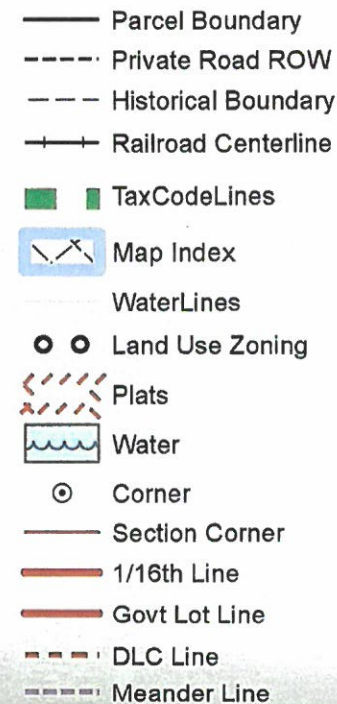

Order No: 250505

LEGAL DESCRIPTION

A tract of land situated in the Southwest one-quarter of Section 25, Township 2 South, Range 1 East, of the Willamette Meridian, in the County of Clackamas and State of Oregon, being Tract 31 and a portion of Tracts 30 and 32, SHANNON ACRE TRACTS, being more particularly described as follows:

Beginning at a point on the Southerly right of way line of Rosemont Drive (County Road No. 82), which bears South 80°11'47" East 81.00 feet from a 1/2 inch iron pipe at the Northwest corner of Tract 32, SHANNON ACRES TRACTS; thence South 00°07'36" West along the Northerly extension of the Westerly line of LIVERMORE'S SUBDIVISION NO. 1, and the Westerly line thereof, 407.32 feet to a 5/8 inch iron rod on the Northerly right of way line of Ridge Lane; thence North 89°46'02" West along said Northerly right of way line, 348.00 feet; thence North 00°00'24" West parallel with and 180.00 feet Easterly when measured at right angles to the Westerly line of said Tract 30 a distance of 280.15 feet to a 5/8 inch iron rod; thence North 89°59'36" East 84.00 feet to a 5/8 inch iron rod; thence North 00°00'24" West 43.50 feet to a 5/8 inch iron rod; thence North 89°59'36" East 73.20 feet to a 5/8 inch iron rod thence North 05°46'13" East 113.54 feet to a 5/8 inch iron rod on the Southerly right of way line of Rosemont Drive; thence South 80°11'47" East along said right of way line, 175.00 feet to the point of beginning.

21E25CB 00100

Encumbrances, continued

1. Covenants, conditions and restrictions, but omitting restrictions if any, based on race, color, religion, sex, handicap, familial status or national origin, unless and only to the extent that said covenant, (a) is exempt under Chapter 42, Section 1607 of the United States Code or (b) relates to handicap but does not discriminate against handicapped persons, imposed by instrument, including the terms and provisions thereof.

Recorded: April 30, 1962

Book: 602

Page: 791

(Affects Lot 30)



2

28  
11  
1111100168-0255  
505052  
CHICAGO TITLE INSURANCE COMPANY

AFTER RECORDING RETURN TO:

Jerry W. Burns  
Christine C. Burns

1430 Rosemont Road

West Linn, OR 97068

Until a change is requested all tax statements shall be sent to the following address:

Jerry W. Burns  
Christine C. Burns  
1430 Rosemont Road  
West Linn, OR 97068

Order No: 250505

Clackamas County Official Records  
Sherry Hall, County Clerk

2003-066496

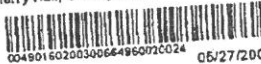

\$31.00

05/27/2003 02:13:15 PM

0-0  
110.00 \$11.00 \$10.00  
Caret Size: BEVERLY

WARRANTY DEED - STATUTORY FORM  
(INDIVIDUAL OR CORPORATION)

JAY W. JORGENSEN and ANGELA K. JORGENSEN, as tenants by the entirety

Grantor, conveys and warrants to JERRY W. BURNS and CHRISTINE C. BURNS,  
husband and wife

Grantee, the following described real property free of encumbrance except as specifically  
set forth herein:

(Continued)

This instrument will not allow use of the property described in this instrument in violation  
of applicable land use laws and regulations. Before signing or accepting this instrument,  
the person acquiring fee title to the property should check with the appropriate city or  
county planning department to verify approved uses and to determine any limits on lawsuits  
against farming or forest practices as defined in ORS 30.930.

ENCUMBRANCES:

(Continued)

WD

The true consideration for this conveyance is \$440,000.00

Dated April 24, 2003, if a corporate grantor, it has caused its name to  
be signed by its board of directors.

Jay W. Jorgensen

Angela K. Jorgensen

01660081

STATE OF OREGON, County of Multnomah ss.

This instrument was acknowledged before me on April 24, 2003

by Jay W. Jorgensen and Angela K. Jorgensen

This instrument was acknowledged before me on

by

of

Notary Public for Oregon  
My commission expires:

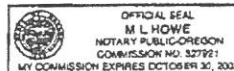



## CITY OF WEST LINN

### CERTIFICATION OF PROPERTY OWNERSHIP

I hereby certify that the attached petition for the annexation of the territory described herein to the City of West Linn contains the names of the owners\* of a majority of the land area of the territory to be annexed, as shown on the last available complete assessment roll.

NAME DJ Sporn

TITLE GIS Cartographer 2

DEPARTMENT A&T

CLACKAMAS COUNTY ASSESSOR'S OFFICE

DATE 4-9-14

\*"Owner" means the owner of the title to real property or the contract purchaser of real property.



## CITY OF WEST LINN

### CERTIFICATION OF LEGAL DESCRIPTION AND MAP

I hereby certify that the description of the property included within the attached petition, located on Assessor's Map 251E25CB, has been checked by me and it is a true and exact description of the property under consideration and the description corresponds to the attached map indicating the property under consideration.

NAME DJ Sporn

TITLE GIS Cartographer 2

DEPARTMENT A&T

CLACKAMAS COUNTY ASSESSOR'S OFFICE

DATE 4-9-14

**DOR 3-P407-2014  
Preliminary Review**



Cadastral Information Systems Unit  
PO Box 14380  
Salem, OR 97309-5075  
fax 503-945-8737

City of West Linn  
Planning Dept.  
Attn: Peter Spir  
22500 Salamo Road, #100  
West Linn, OR 97068

---

Date: 6/19/2014

This letter is to inform you that the map and description for your PLANNED Annex to City of West Linn (ANX-14-01) in Clackamas County have been reviewed per your request. They MEET the requirements for use with an Order, Ordinance, or Resolution which must be submitted to the Clackamas County Assessor and Department of Revenue in final form before March 31, 2015 per ORS 308.225.

Documents received on 6/17/14.

Note: Be sure to include the Approved bearings & distances map in the Final packet filed with DOR.

---

If you have any questions please contact: Matthew Taylor (503) 302-5078