

## Narrative for Trash Compactor at Bolton PS

### City of West Linn – Community Development Code Chapter 55

**A-** The provisions of CDC 55.100 (B)(1) through (4), CDC 55.100 (B)(5) and (6), and CDC 55.085 must be met.

**Response: See individual responses below.**

**B-** An application may be approved only if adequate public facilities will be available to provide service to the property at the time of occupancy.

**Response: Proposed work will not affect public facility at time of occupancy.**

**C –** The Planning Director shall determine the applicability of the approved criteria in subsection A of this section.

**Response: See individual DOWA responses below.**

### Section 55.100 (B)(1)

The buildings and other site elements shall be designed and located so that all heritage trees, as defined in the municipal code, shall be saved. Diseased heritage trees, as determined by the City Arborist, may be removed at his/her direction.

**Response: There is one shrub and one tree being removed as a result of the proposed location of the trash compactor. Neither are heritage trees. New landscaping around the trash compactor is being proposed.**

### Section 55.100 (B)(2)

All heritage trees, as defined in the municipal code, all trees and clusters of trees ("cluster" is defined as three or more trees with overlapping drip lines; however, native oaks need not have an overlapping drip line) that are considered significant by the City Arborist, either individually or in consultation with certified arborists or similarly qualified professionals, based on accepted arboricultural standards including consideration of their size, type, location, health, long term survivability, and/or numbers, shall be protected pursuant to the criteria of subsections (B)(2)(a) through (f) of this section. In cases where there is a difference of opinion on the significance of a tree or tree cluster, the City Arborist's findings shall prevail. It is important to acknowledge that all trees are not significant and, further, that this code section will not necessarily protect all trees deemed significant.

**Response: There is one shrub and one tree being removed as a result of the proposed location of the trash compactor. Neither are heritage trees. New landscaping around the trash compactor is being proposed.**

### CDC 55.100(B)(3)

The topography and natural drainage shall be preserved to the greatest degree possible.

**Response: The proposed concrete pad on which the trash compactor will sit will be sloped to drain. Grading is proposed to provide transition between disturbed areas to adjacent undisturbed areas. Gravel transition is proposed between new slab and existing gravel.**

### CDC 55.100(B)(4)

The structures shall not be located in areas subject to slumping and sliding. The Comprehensive Plan Background Report's Hazard Map, or updated material as available and as deemed acceptable by the Planning Director, shall be the basis for preliminary determination.

**Response: This section is satisfied because the property is geologically stable.**

**CDC 55.100 (B)(5)**

There shall be adequate distance between on-site buildings and on-site and off-site buildings on adjoining properties to provide for adequate light and air circulation and for fire protection.

**Response: This does not apply in this case.**

**CDC 55.100 (B)(6)**

Architecture/Style

**Response: This does not apply in this case.**

**CDC 55.100 (B)(7)**

Transportation Planning Rule (TPR) compliance. The automobile shall be shifted from a dominant role, relative to other modes of transportation, by the following means.

**Response: This does not apply in this case. It should be noted that the addition of the trash compactor to the site will reduce the number of trash pickups made by vehicular activity by one fourth.**

**CDC 55.100 (A)(5)**

Chapter 42 Clear Vision Areas

**Response: The proposed location of the trash compactor does not alter or impede on existing clear vision areas for streets and access ways. The location of the proposed trash compactor is not near a vehicular intersection; it sits back from the street closer to the existing building and is contained within an existing fence line that runs parallel to the access street. The compactor is placed appropriately off of an existing service drive.**

**CDC 55.100(A)(6)**

Chapter 44 Fences

**Response: New fencing, both 6'-0" in height and 3'-0" in height to match the height of an adjacent existing fence, will be provided on three sides of the proposed trash compactor and concrete pad. The north side is addressed with the existing masonry wall of the existing covered play area. This complies with 44.020A. The proposed fencing is setback from the existing streets and sideways and is adjacent to existing site fencing. The new fencing is not located on top of a retaining wall. The proposed fencing will aid to screen any service or repair required to the proposed trash compactor as well as any adjacent residential properties.**

**CDC 55.100 (A)(10)**

Chapter 54 Landscaping

**Response: one shrub and one existing tree are to be removed and the existing sidewalk re-routed to accommodate the proposed trash compactor. Any existing planters will be removed/relocated to avoid conflict with proposed work. New landscaping is proposed on the south side of the proposed trash compactor area.**

**CDC 55.100(C)**

Compatibility between adjoining uses, buffering and screening.

**Response: A fence will be provided on all three sides of the proposed trash compactor to serve as a visual barrier. The north wall is created by the existing masonry wall of the existing covered play.**

**CDC 55.100 (D)(3)**

Structures or on-site activity areas which generate noise, lights, or glare shall be buffered from adjoining residential uses in accordance with the standards in subsection C of this section where applicable. Businesses or activities that can reasonably be expected to generate noise shall undertake and submit appropriate noise studies and mitigate as necessary. (See CDC 55.110(B)(11) and 55.120(M).)

**Response: There are no light or glare issues with the proposed trash compactor. No new or additional lighting is proposed. The location of the proposed compactor is greater than 25' from adjacent dwellings. The compactor will be run Monday through Friday during working/business hours (8am-5pm). The compaction time is less than 90 seconds; the unit is self-contained and will not produce any "rattling" when being emptied. The addition of the trash compactor to the site will reduce the amount of trash pickups made to this site by one fourth.**

**CDC 55.100 (I)(5)**

Solid waste and recycling storage areas. Appropriately sized and located solid waste and recycling storage areas shall be provided. Metro standards shall be used.

**Response: Recycling and waste pickup are already addressed onsite, and meets or exceed Metro requirements. The addition of the trash compactor to the site will reduce the amount of trash pickups onsite.**

**CDC 55.100 (J)(8)**

Security fences for utilities (e.g., power transformers, pump stations, pipeline control equipment, etc.) or wireless communication facilities may be up to eight feet tall in order to protect public safety. No variances are required regardless of location.

**Response: The trash compactor is fully fenced, and the height of the fence does not exceed 6'-0" in height.**

**CDC 55.100 (O)**

Refuse and recycling standards:

1. All commercial, industrial and multi-family developments over five units requiring Class II design review shall comply with the standards set forth in these provisions. Modifications to these provisions may be permitted if the Planning Commission determines that the changes are consistent with the purpose of these provisions and the City receives written evidence from the local franchised solid waste and recycling firm that they are in agreement with the proposed modifications.
2. Compactors, containers, and drop boxes shall be located on a level Portland cement concrete pad, a minimum of four inches thick, at ground elevation or other location compatible with the local franchise collection firm's equipment at the time of construction. The pad shall be designed to discharge surface water runoff to avoid ponding.

**Response: Item 1 does not apply in this case as the trash compactor falls under a Class I Design Review (per City Requirements). In regards to item 2, the trash compactor is to be located on a 6" thick concrete pad on compacted subgrade. The new concrete pad will be sloped to drain to avoid ponding. In addition, the compactor unit is self-contained, and spillage will not occur when being moved.**



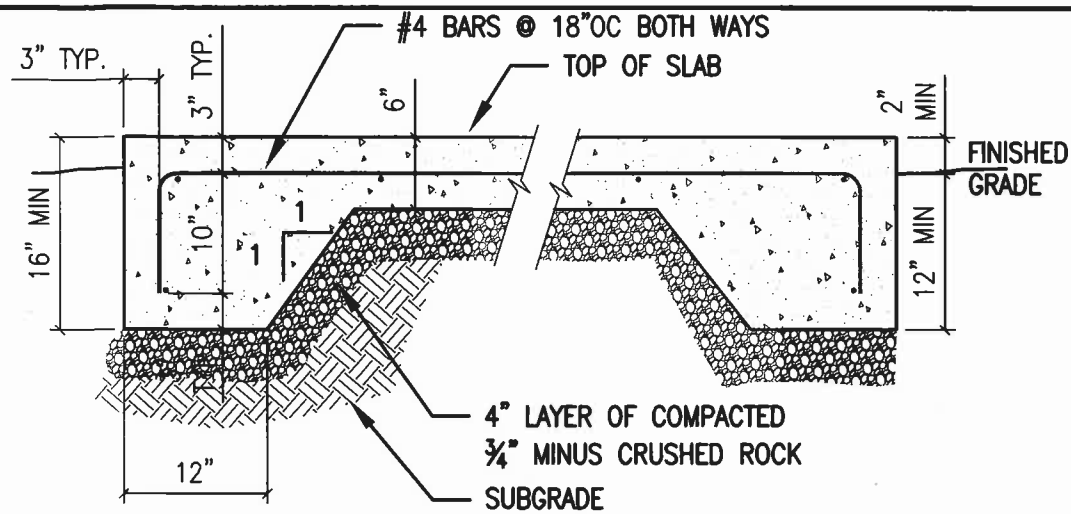

**NOTE:**  
 SEE LANDSCAPE DRAWINGS FOR FENCE AND FENCE FOOTING DETAILS.  
 REINFORCING STEEL: GRADE 60  
 CONCRETE STRENGTH:  $f_c' = 3000$  psi

**CONCRETE SLAB DETAIL**

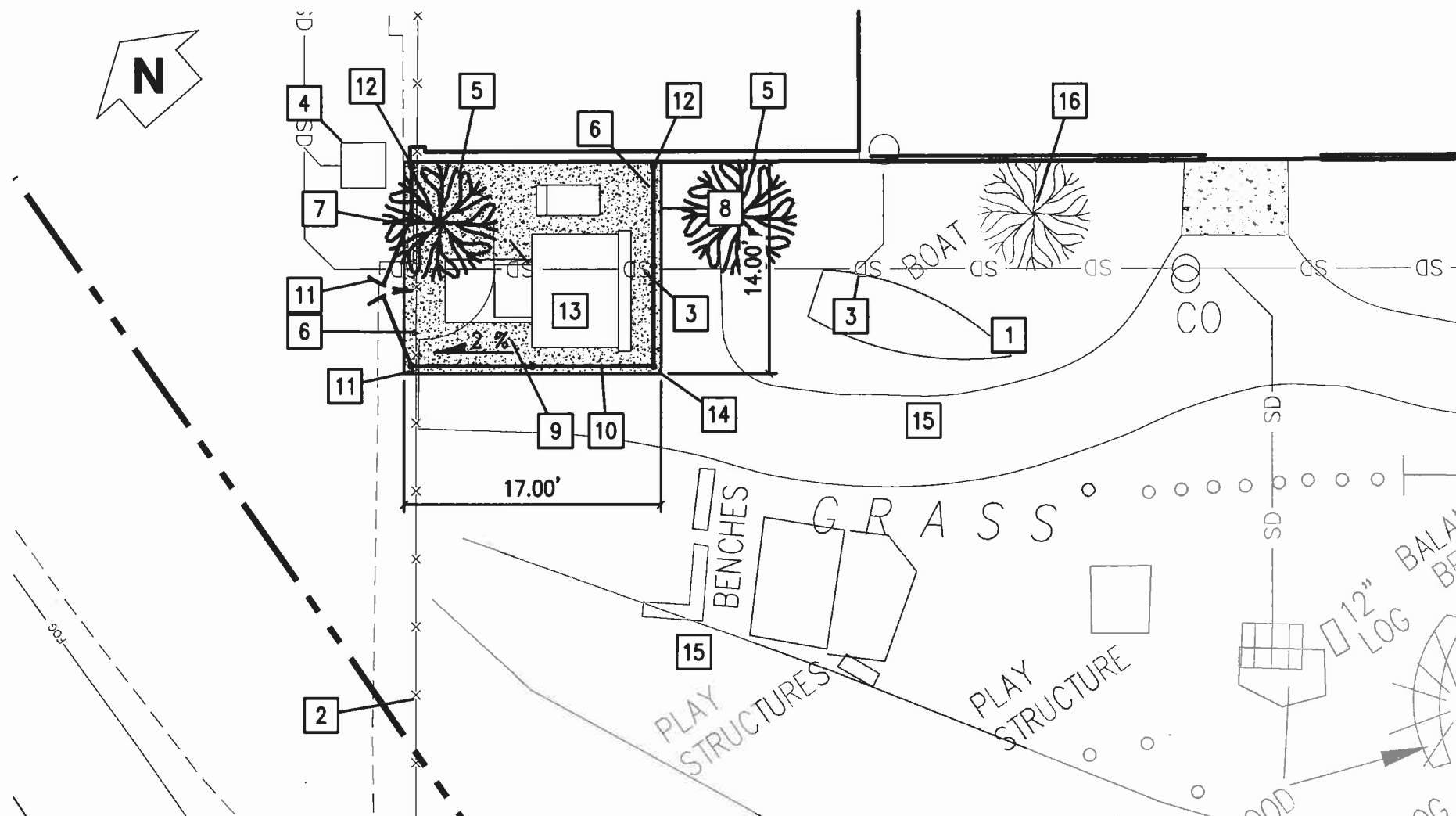

**1 COMPACTOR INSTALLATION**  
 B0-SKC1 B0-SKC1 SCALE: 1"=10'-0"

**CONSTRUCTION NOTES**

- 1 SAVE AND PROTECT EXISTING SIDEWALK.
- 2 SAVE AND PROTECT EXISTING FENCE.
- 3 SAVE AND PROTECT EXISTING STORM DRAINAGE PIPE.
- 4 INSTALL INLET PROTECTION. SEE DETAIL 8 ON SHEET C1.03.
- 5 REMOVE EXISTING TREE AND LANDSCAPING.
- 6 REMOVE EXISTING 3' CHAIN LINK FENCE AND GATE.
- 7 SAWCUT STRAIGHT EDGE IN ASPHALT TO CONSTRUCT PAD.
- 8 SAWCUT EXISTING CONCRETE TO CONSTRUCT NEW PAD.
- 9 INSTALL 17'x14'x6" THICK CONCRETE PAD ON COMPACTED GRAVEL SUBGRADE. SLOPE CONCRETE PAD TOWARD ACCESS AS SHOWN, MAX. SLOPE 2%.
- 10 INSTALL 6' BLACK VINYL COATED CHAIN LINK FENCE AROUND COMPACTOR PAD AS SHOWN. PROVIDE "SIGHT OBSCURING" BLACK VINYL SLATS. SEE LANDSCAPE DRAWINGS FOR DETAILS.
- 11 PROVIDE 10' WIDE GATE. BLACK VINYL COATED CHAIN LINK FENCE AROUND COMPACTOR PAD AS SHOWN. PROVIDE "SIGHT OBSCURING" BLACK VINYL SLATS. SEE LANDSCAPE DRAWINGS FOR DETAILS.
- 12 NO GAP ALLOWED BETWEEN EXISTING FENCE AND NEW FENCE TO BE CONNECTED; OR NEW FENCE AND EXISTING MASONRY WALL.
- 13 INSTALL COMPACTOR (PROVIDED BY OTHERS)
- 14 CONCRETE SLAB TO BE APPROXIMATELY 3" ABOVE ADJACENT GRADE. GRADE TO PROVIDE SMOOTH TRANSITION FROM DISTURBED AREA TO EXISTING UNDISTURBED AREA. SEE LANDSCAPE DRAWINGS FOR SURFACE RESTORATION.
- 15 SEE LANDSCAPE DRAWINGS FOR ADDITIONAL INFORMATION.
- 16 SAVE AND PROTECT EXISTING SHRUB.

 15575 SW SEQUOIA PKWY, SUITE 140 PORTLAND, OR 97224 PH: 503-226-3921 FAX: 503-226-3926		PROJECT BOLTON PRIMARY SCHOOL			
		TITLE COMPACTOR INSTALLATION			
DESIGNED PRT	DRAWN RAG	APPROVED PRT	DATE 04/18/11	PROJECT NO. 10884-9015	DWG NO. BO-SKC1

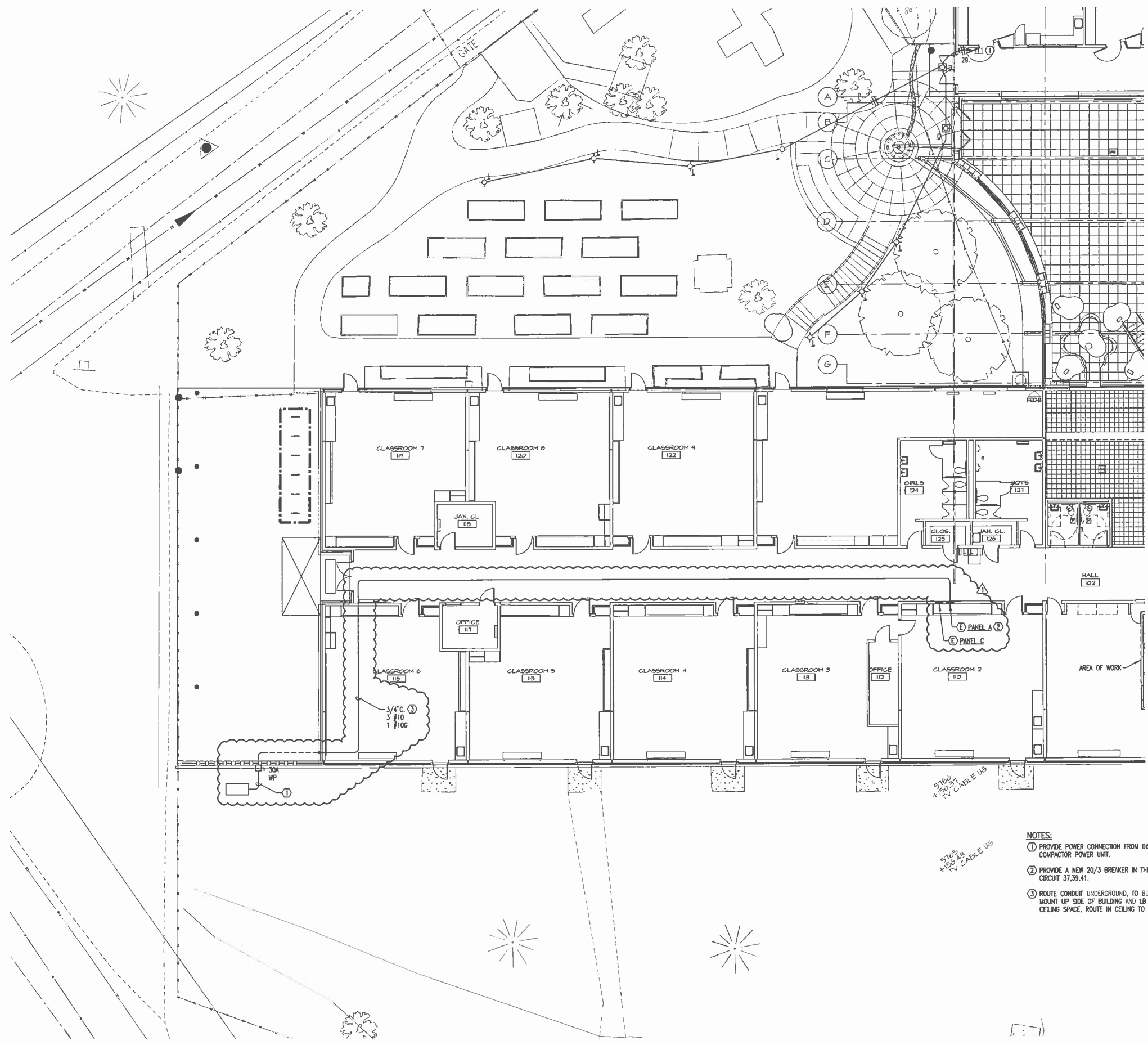

- NOTES:**
- ① PROVIDE POWER CONNECTION FROM DISCONNECT TO COMPACTOR POWER UNIT.
  - ② PROVIDE A NEW 20/3 BREAKER IN THE EXISTING PANEL, CIRCUIT 37,39,41.
  - ③ ROUTE CONDUIT UNDERGROUND, TO BUILDING, SURFACE MOUNT UP SIDE OF BUILDING AND LB INTO CLASSROOM CEILING SPACE, ROUTE IN CEILING TO PANEL.

SITE PLAN - POWER & LIGHTING  
SCALE 1/8"=1'-0"



**BOLTON PRIMARY SCHOOL-ADDITION/REMODEL**  
**5933 SW HOLMES STREET WEST LINN, OR 97068**  
West Linn-Wilsonville School District #3JT  
22210 SW STAFFORD RD, TUALATIN, OR 97062  
t: (503) 673 7000 f: (503) 673 7001



phase	
date	04/18/2011
revisions	

project # 09002  
SITE PLAN - LIGHTING  
**BO-E0.2**

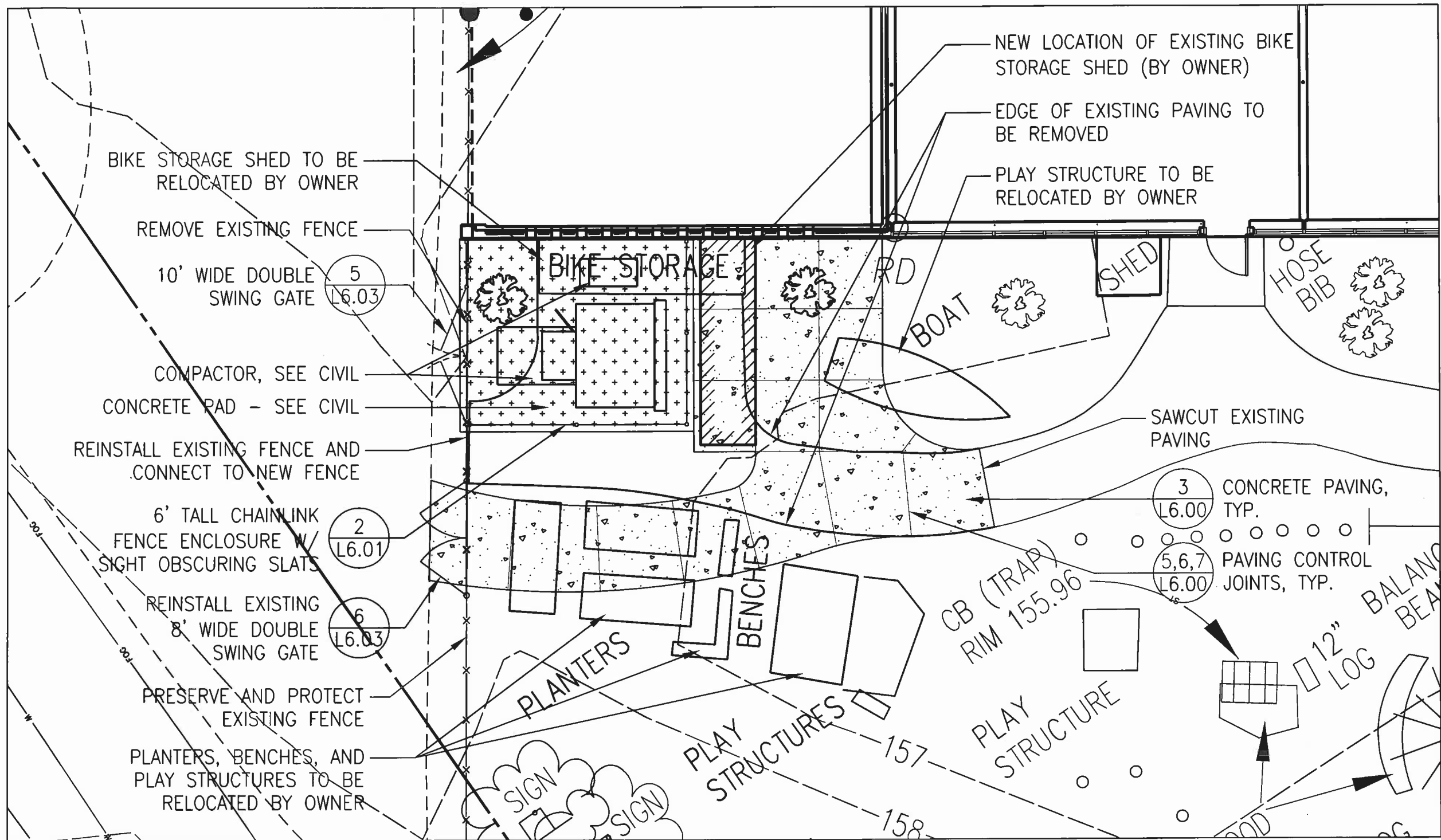

2 TRASH COMPACTOR MATERIALS PLAN  
SCALE: 1/8" = 1'-0"

PLAN



DULL OLSON WEEKES  
architects inc.

907 SW STARK STREET, PORTLAND, OREGON 97205  
t: 503 226 6950 f: 503 273 9192 www.doww.com

**BOLTON PRIMARY SCHOOL - ADDITION / REMODEL**  
West Linn-Wilsonville School District #3JT

22210 SW STAFFORD RD  
TUALATIN, OR 97062  
t: (503) 673 7976  
f: (503) 673 7044

phase	Permit
date	04/18/2011
project #	09002
reference	BO-L1.00

**BO-L009**

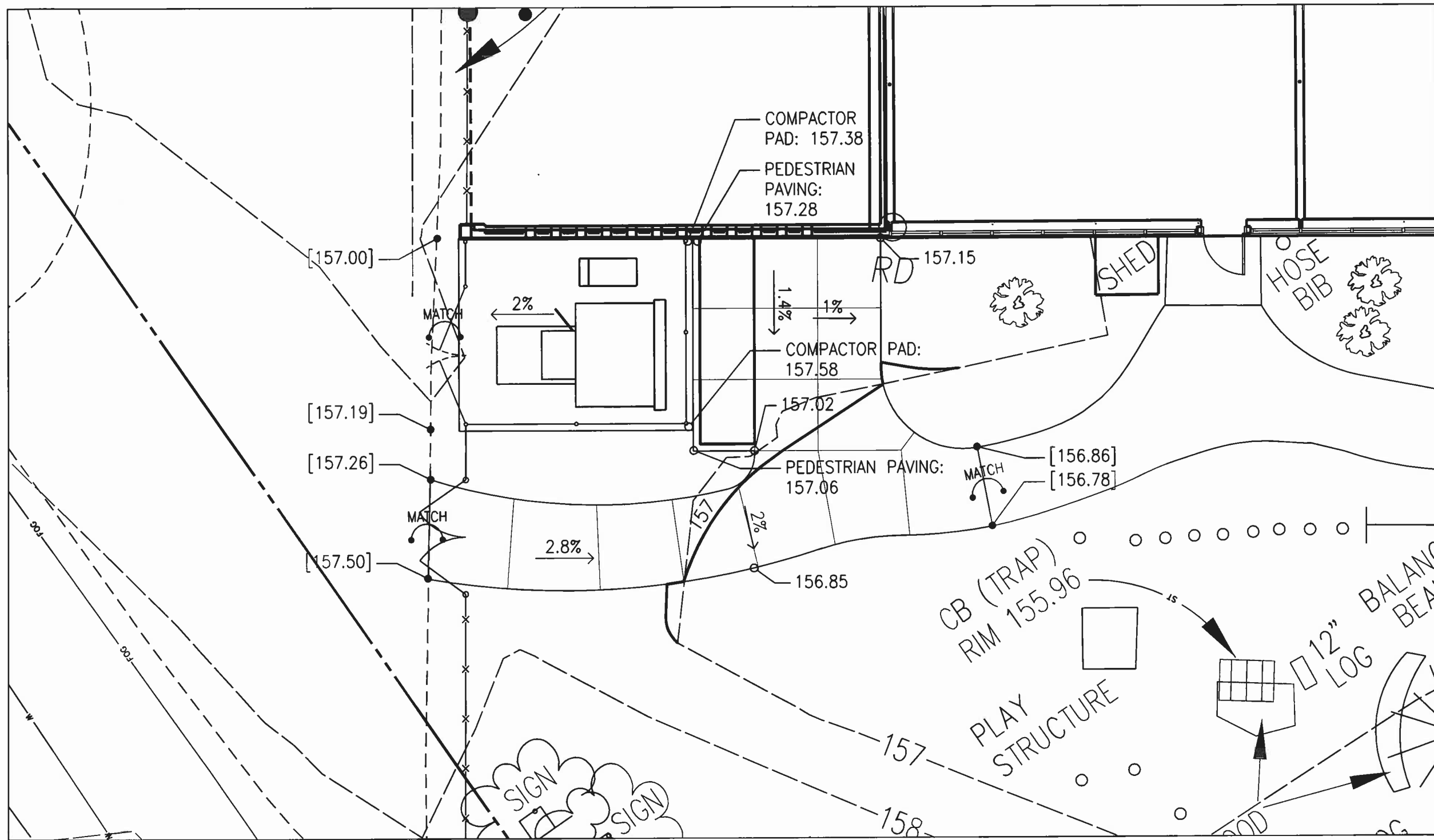

1 TRASH COMPACTOR GRADING PLAN  
 SCALE: 1/8" = 1'-0"

PLAN



DULL OLSON WEEKES  
 architects inc.

907 SW STARK STREET, PORTLAND, OREGON 97205  
 t: 503 226 6950 f: 503 273 9192 www.dowva.com

**BOLTON PRIMARY SCHOOL - ADDITION / REMODEL**

West Linn-Wilsonville School District #3JT

22210 SW STAFFORD RD  
 TUALATIN, OR 97062  
 t: (503) 673 7976  
 f: (503) 673 7044

phase	Permit
date	04/18/2011
project #	09002
reference	BO-L2.00

**BO-L010**





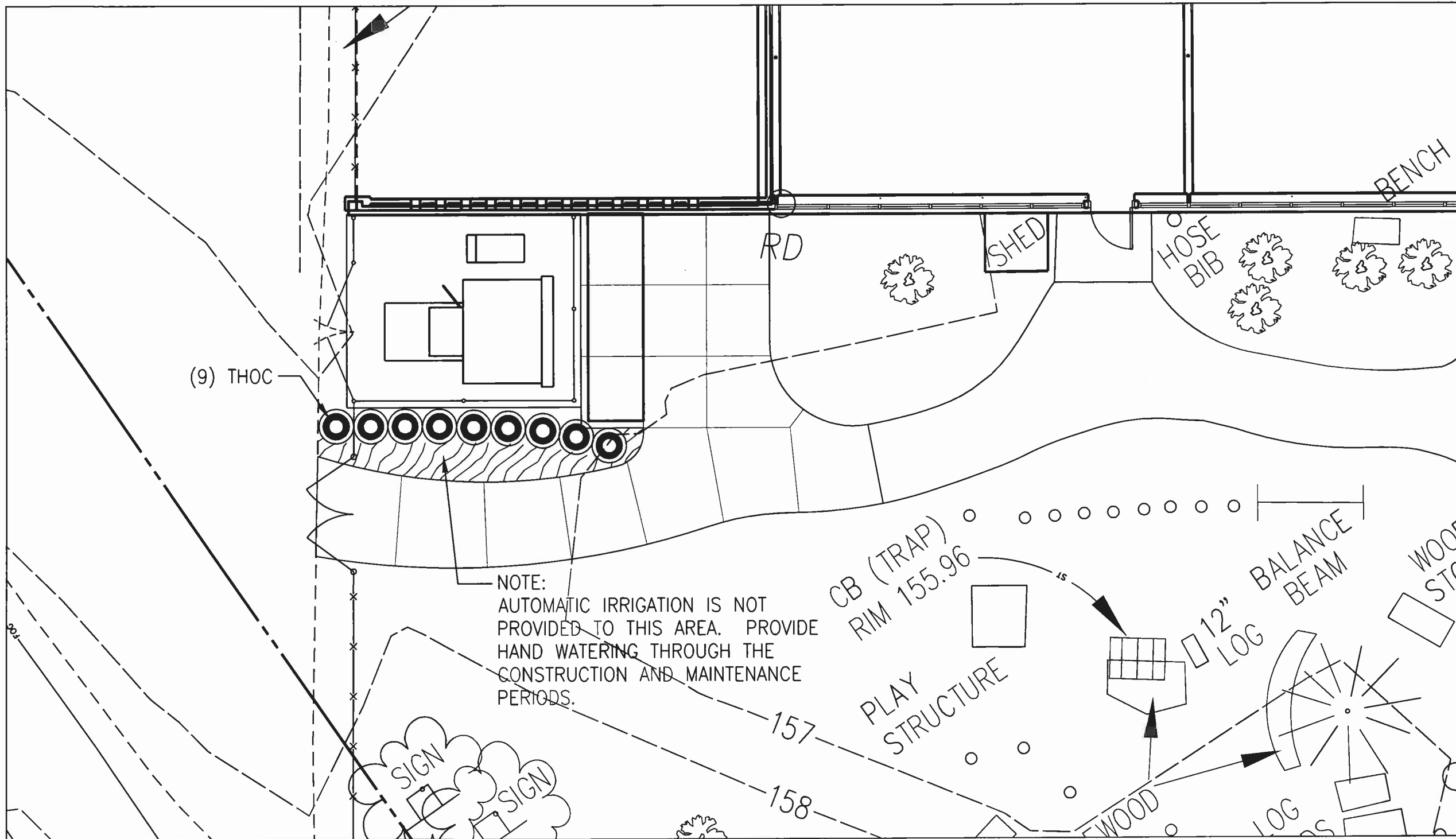

1

TRASH COMPACTOR PLANTING PLAN

SCALE: 1/8" = 1'-0"

PLAN



DULL OLSON WEEKES  
architects inc.

907 SW STARK STREET, PORTLAND, OREGON 97205  
t: 503 226 6950 f: 503 273 8192 www.doww.com

BOLTON PRIMARY SCHOOL - ADDITION / REMODEL

West Linn-Wilsonville School District #3JT

22210 SW STAFFORD RD  
TUALATIN, OR 97062  
t: (503) 673 7976  
f: (503) 673 7044

phase	Permit
date	04/18/2011
project #	09002
reference	BO-L5.00

**BO-L012**

# PLANT SCHEDULE

PLANTS TO BE SELECTED FROM THE FOLLOWING

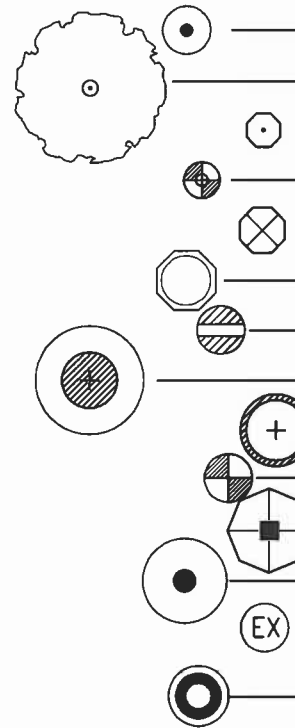

KEY	BOTANICAL NAME	COMMON NAME	SIZE/CONDITION	SPACING	NOTES
	<b>TREES</b>				
STKO	STEWARTIA KOREANA	KOREAN STEWARTIA	MULTI STEM/B&B	AS SHOWN	TRUNK HEIGHT 4'-6'
	<b>SHRUBS</b>				
BUSE	BUXUS SEMPERVIRENS 'ARGENTEOVARIEGATA'	VARIEGATED BOXWOOD	5 GAL.	AS SHOWN	
GUMA	GUNNERA MANICATA	GIANT RHUBARB	5 GAL.	AS SHOWN	SPECIMEN, 3-5 CANES
HEHA	HEMEROCALLIS X 'HAPPY RETURNS'	HAPPY RETURNS DAYLILY	1 GAL.	AS SHOWN	
CAAC	CALAMAGROSTIS ACUTIFLORA X KARL FOERSTER	FEATHER REED GRASS	1 GAL.	AS SHOWN	
POMU	POLYSTICHUM MUNITUM	WETERN SWORD FERN	1 GAL.	AS SHOWN	
RHPJ	RHODODENDRON x PJM	PJM RHODODENDRON	2 GAL.	AS SHOWN	
SPBU	SPIRAEA X BUMALDA 'LIMEMOUND'	LIMEMOUND SPIREA	2 GAL.	AS SHOWN	
SPNI	SPIRAEA X NIPPONICA 'SNOWMOUND'	SNOWMOUND SPIREA	2 GAL.	AS SHOWN	
SPHA	SPIRAEA X NIPPONICA 'HALWARDS SILVER'	COMPACT NIPPON SPIREA	2 GAL.	AS SHOWN	
VEHY	VERBENA X HYBRIDA 'HOMESTEAD'	PURPLE SPREADER VERBENA	1 GAL.	AS SHOWN	
ILGL	ILEX GLABRA 'NORDIC'	NORDIC INKBERRY (MALE PLANTS ONLY)	5 GAL.	AS SHOWN	
AUJA	AUCUBA JAPONICA 'CRASSIFOLIA'	JAPANESE ACUBA (MALE PLANTS ONLY)	5 GAL.	AS SHOWN	
EX	SALVAGED EXISTING VARIEGATED BOXWOOD				
THOC	THUJA OCCIDENTALIS 'EMERALD'	EMERALD ARBORVITAE	5'-6' HEIGHT	AS SHOWN	PROVIDE MATCHED HEIGHT SHRUBS
	<b>GROUNDCOVERS</b>				
	ARCTOSTAPHYLOS UVA-URSI	KINNICKINICK	1 GAL. CONT.	12" O.C.	

phase	Permit
date	04/18/2011
project #	09002
reference	BO-L5.00

**BO-L013**

**NOTES:**

1. RE-INSTALL EXISTING FABRIC, OR PROVIDE 9-GAUGE STEEL WIRE WOVEN IN A 2" MESH, W/1.2 OUNCE ZINC COATING AND BLACK VINYL-COATED.
2. ALL FENCE COMPONENTS TO BE VINYL COATED USING UNITED STATES STEEL PROCESS COLOR - BLACK.
3. BEND DOWN AND KNUCKLE TOP BARB SELVAGES OF FABRIC.
4. END, CORNER, AND PULL POSTS SHALL BE 2" DIA. POSTS, GALV. AND VINYL-COATED.
5. INTERMEDIATE POSTS SHALL BE 2"  $\phi$  GALVANIZED STEEL AND VINYL-COATED.
6. LINE POSTS SHALL BE 1-1/2"  $\phi$  GALVANIZED STEEL AND VINYL-COATED.
7. CONTRACTOR TO SUBMIT CHAIN LINK FENCING SHOP DRAWINGS FOR APPROVAL BY ARCHITECT.

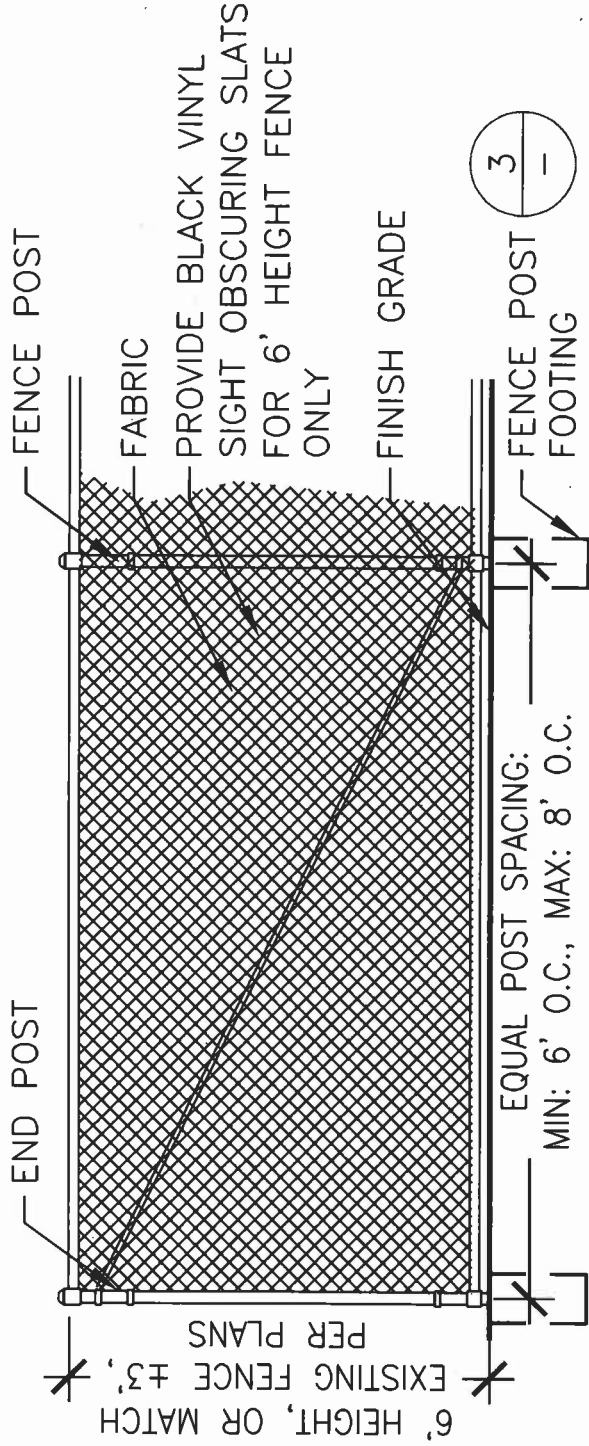

2

**CHAIN LINK FENCE**

SCALE: 3/8" = 1' - 0"

SECTION

BOLTON PRIMARY SCHOOL - ADDITION / REMODEL

West Linn-Wilsonville School District #3JT

22210 SW STAFFORD RD  
TUALATIN, OR 97062  
t: (503) 673 7976  
f: (503) 673 7044



DULL OLSON WEEKES architects inc.

907 SW STARK STREET | PORTLAND, OREGON 97205  
t: 503 226 6950 | f: 503 273 9192 | www.dowa.com

phase	Permit
date	04/18/2011
project #	09002
reference	BO-L014

**BO-L014**



DULL OLSON WEEKES  
architects inc.

907 SW STARK STREET | PORTLAND, OREGON 97205  
t: 503 226 6950 f: 503 273 9192 www.dowa.com

BOLTON PRIMARY SCHOOL - ADDITION / REMODEL

West Linn-Wilsonville School District #3JT

22210 SW STAFFORD RD  
TUALATIN, OR 97062  
t: (503) 673 7976  
f: (503) 673 7044

phase	Permit
date	04/18/2011
project #	09002
reference	BO-L6.01

**BO-L015**

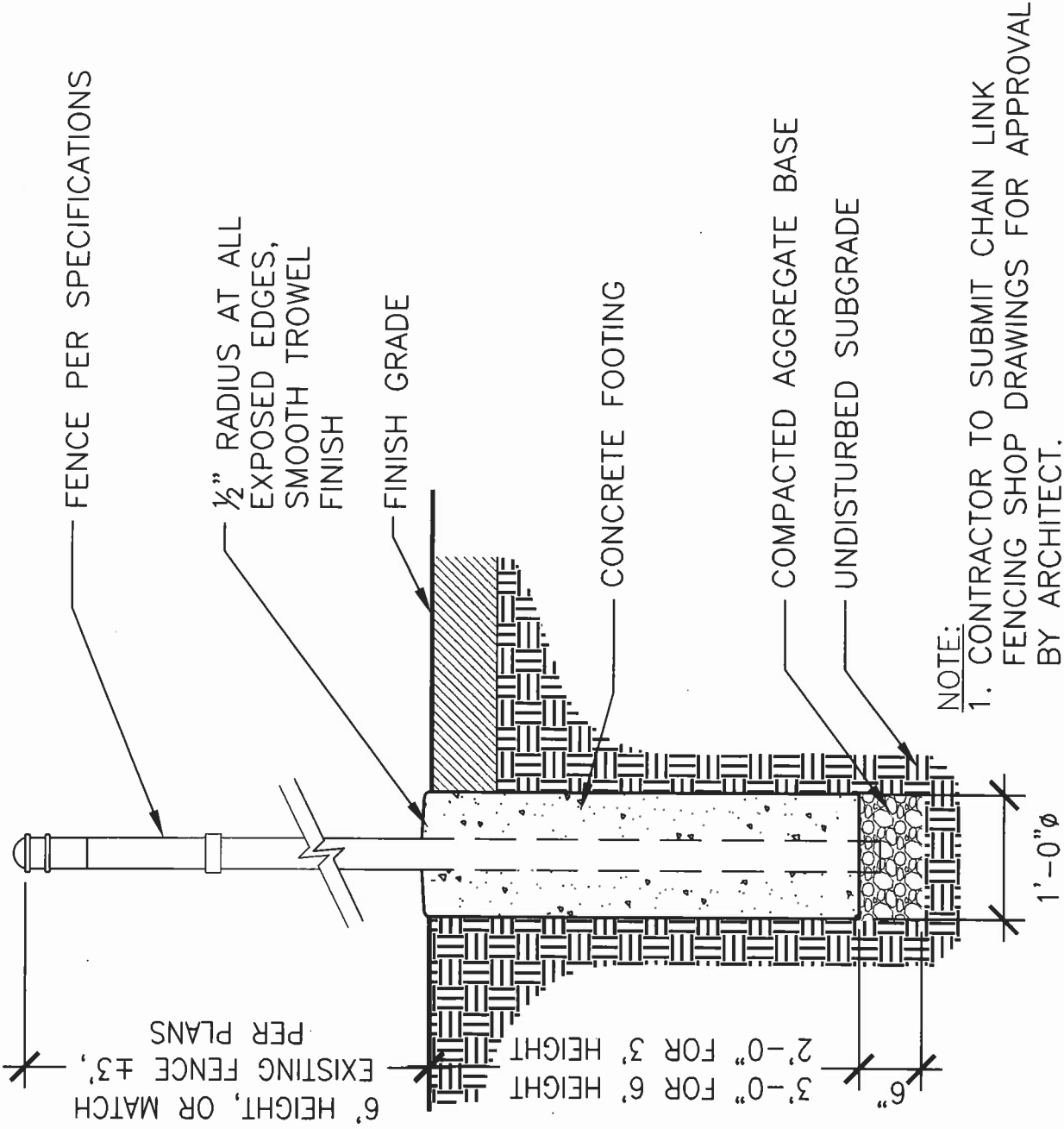

NOTE:  
1. CONTRACTOR TO SUBMIT CHAIN LINK  
FENCING SHOP DRAWINGS FOR APPROVAL  
BY ARCHITECT.

**3** FENCE POST FOOTING  
SCALE: 3/4" = 1' - 0"

SECTION

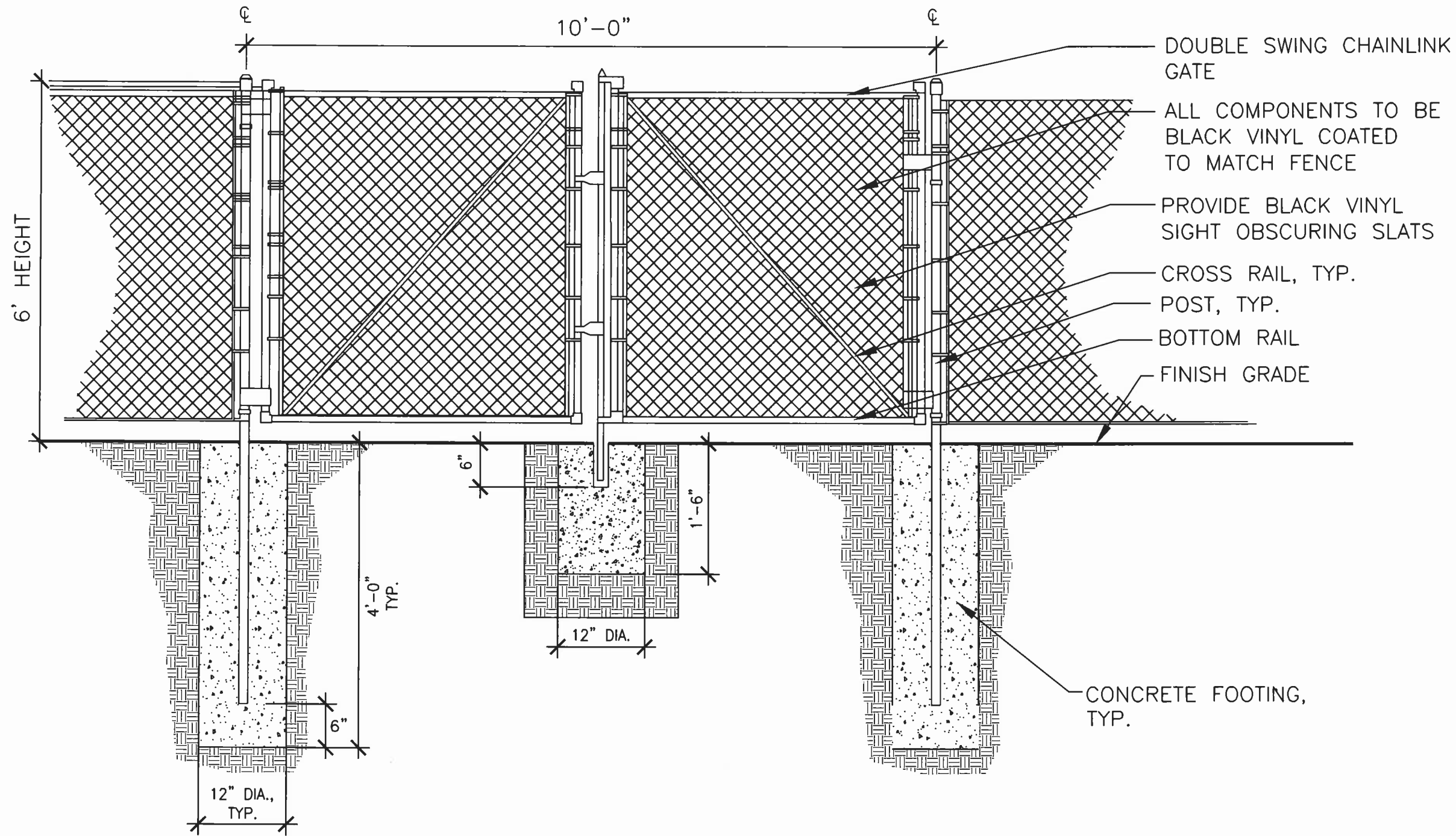

5 10' DOUBLE SWING GATE AT COMPACTOR  
SCALE: 3/4" = 1' - 0"

SECTION



DULL OLSON WEEKES  
architects inc.

907 SW STARK STREET, PORTLAND, OREGON 97205  
t: 503 226 6950 f: 503 273 9192 www.dowa.com

BOLTON PRIMARY SCHOOL - ADDITION / REMODEL

West Linn-Wilsonville School District #3JT

22210 SW STAFFORD RD  
TUALATIN, OR 97062  
t: (503) 673 7976  
f: (503) 673 7044

phase	Permit
date	04/18/2011
project #	09002
reference	BO-L6.03

**BO-L016**

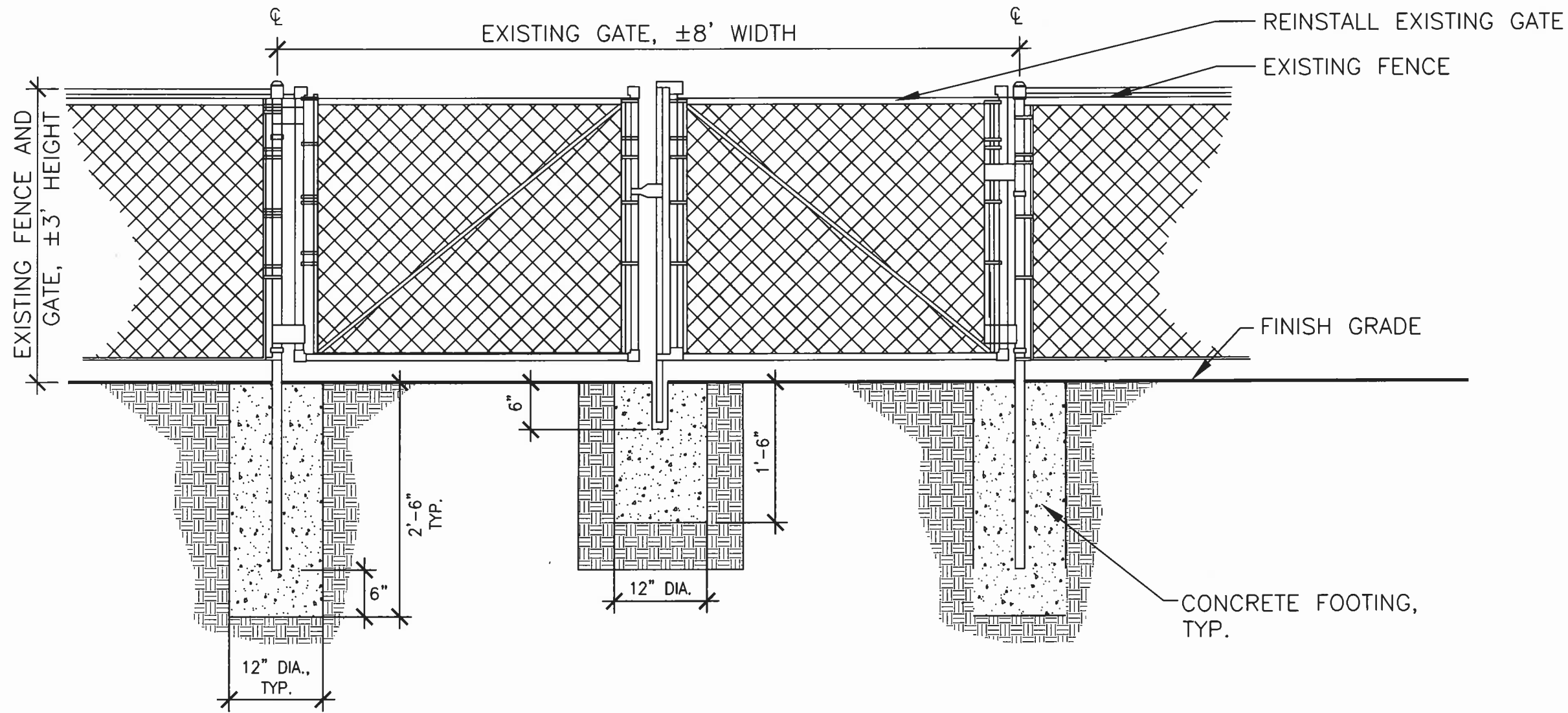

6 8' DOUBLE SWING GATE AT PATH  
 SCALE: 3/4" = 1' - 0"

SECTION

BOLTON PRIMARY SCHOOL - ADDITION / REMODEL

West Linn-Wilsonville School District #3JT

22210 SW STAFFORD RD  
 TUALATIN, OR 97062  
 t: (503) 673 7976  
 f: (503) 673 7044

DULL OLSON WEEKES  
 architects inc.



907 SW STARK STREET, PORTLAND, OREGON 97205  
 t: 503 226 6950 f: 503 273 9192 www.dowa.com

phase	Permit
date	01/18/2011
project#	09002
reference	BO-L6.03

**BO-L017**

# RJ-88 Series Self-Contained Compactor/Containers

Marathon's RJ-88 Series Self-Contained are ideal for waste with high liquid content. Each RJ-88 stores liquid and helps control insects and odor problems. **Containers are factory tested and certified to be leak free!**

▼ The RJ-88SC and RJ-88UC feature a **hopper** to double or triple capacity.

▼ They are easy to load from ground or dock level continuously fed while the unit is cycling.

▼ With **rear-end pick-up** (except for the unit can be loaded from either end. This is especially useful perpendicular to a dock.

**Oil Tank**® with the exclusive **oil feature**, funnels any liquid into compaction into an enclosed **oil tank** with the charge box floor. The **oil tank** is discharged at the **oil tank** flushing the container behind the ram.

▼ The **12" high sump area** is designed to provide easier hook access for the roll-off driver and will not interfere with the dumping process.

▼ **Grease fittings** are provided on hinges, guide rollers and ground rollers

▼ Marathon's **Remote Power Pack**, separate from the compactor/container, remains free of damage caused during hauling to and from disposal sites and free of

connections to make **two**, simple-to-use, hydraulic quick disconnects couple power unit to packing head. **Weather Cover** and the **UL & CSA Rated Motor Control Panel** are standard equipment.

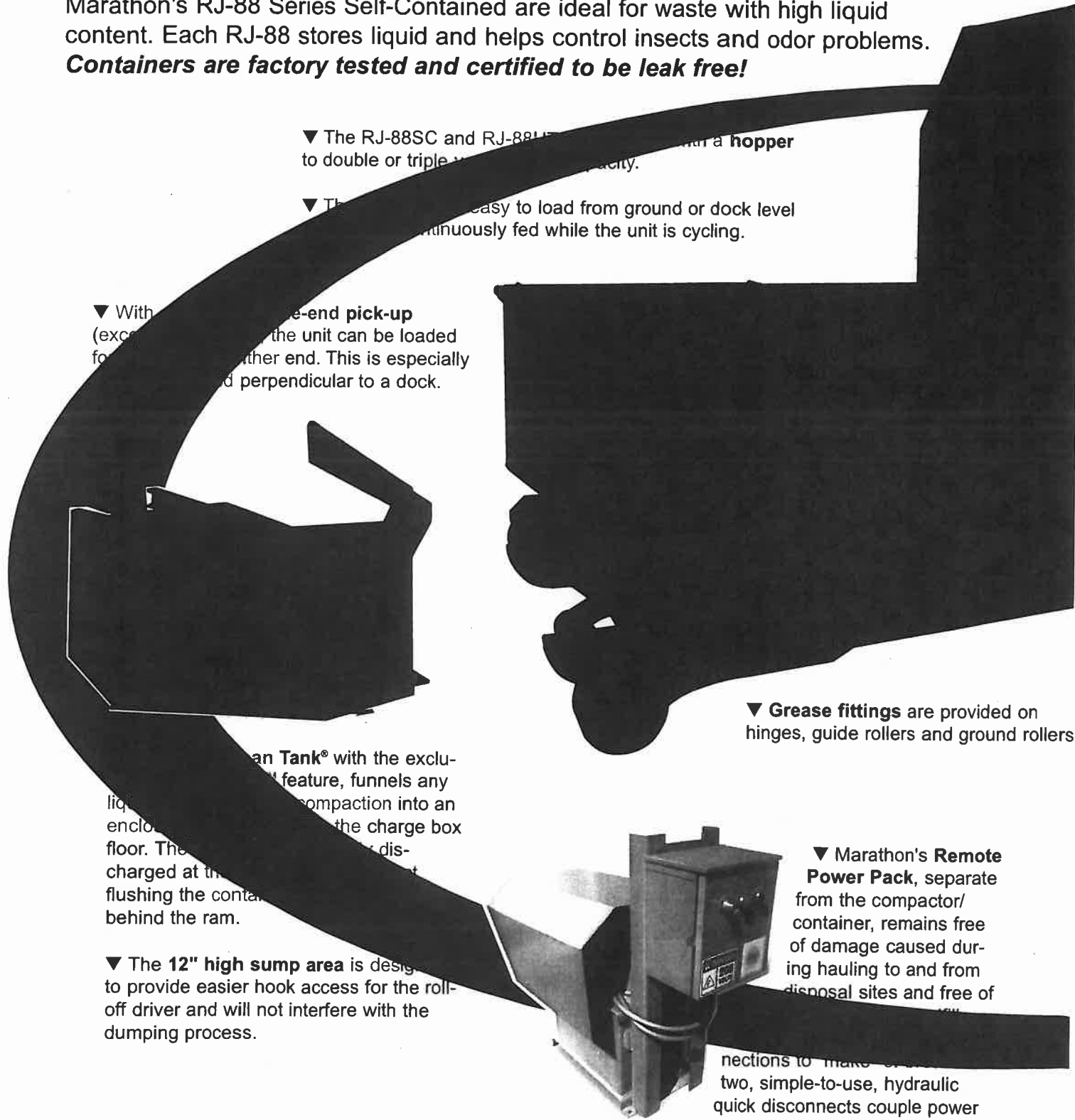



*Cuts installation costs by half over conventional compaction systems!*

Patented  
**Cyclic Control System**

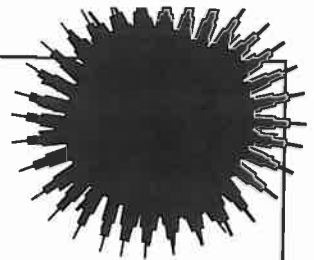

**CYCON's Unique Features:**

- ▼ Reliable, solid state circuitry eliminates all pressure and limit switches.
- ▼ Extends wear life of cylinder and hoses – guaranteed by CYCON's no-shock cycle control.
- ▼ Automatic "Container Full Assurance System": ram dwells against the load at full pressure resulting in better compaction.
- ▼ Smoother running, quieter operation.
- ▼ Advanced hydraulic design allows the system to operate at minimum pressure levels except when actually packing solid waste.
- ▼ CYCON assures more accurate Advanced Warning or Container Full options.
- ▼ Dramatically improves cold weather performance.

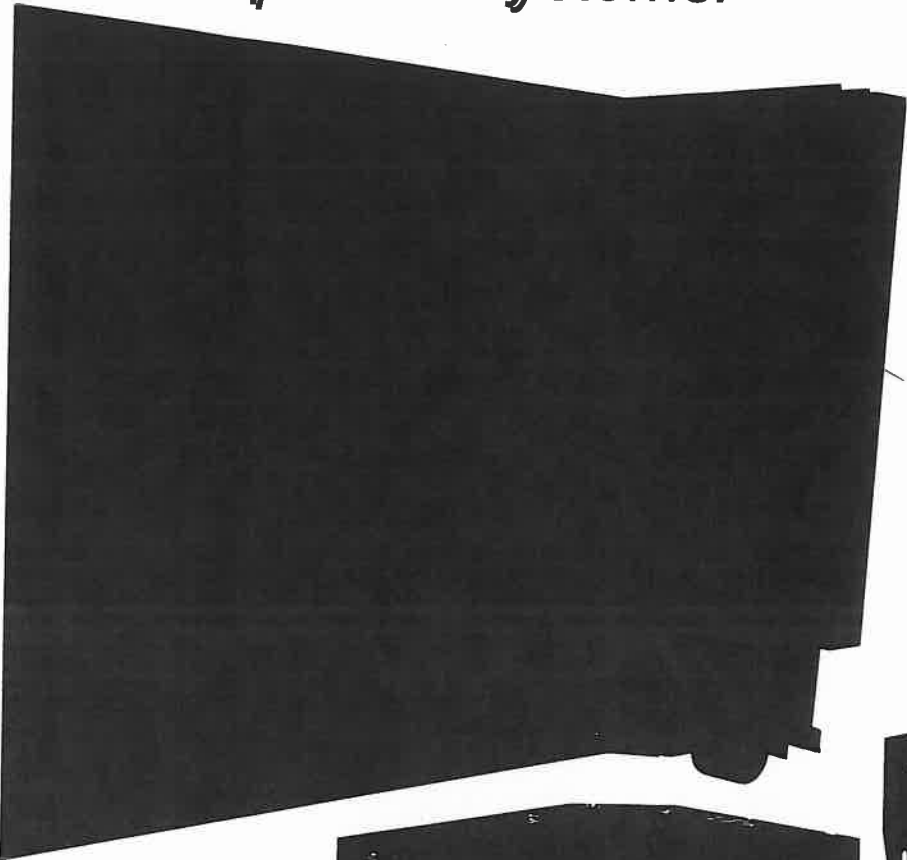

▼ Marathon's exclusive **P-Shaped Door Seal** is specially designed for portable compaction/containers to provide a superior water tight closure. The mounting is engineered for quick and easy seal installation when replacement is necessary, requiring no field fitting, cutting or welding.



▼ The **Double-Hinge** assures liquid retention by actuating uniform seal compression without seal "scrubbing" and damage.



▼ Marathon's "**Bubble Gate**" raised door design adds nearly a full cubic yard to container capacity and provides superior compaction ratios which reduces disposal costs.

▼ The **One-Hand Ratchet** engages the door and eliminates the need to hold the door while operating the latch ratchet. This design allows the operator to use both hands on the ratchet. One easy-to-operate ratchet saves expensive driver and truck time.

**RJ-88HT: with Hydraulic Tailgate Design**

▼ Equipped with hydraulic tailgate, the **RJ-88 HT** is particularly well suited for security chute-fed and dock-fed applications where maneuvering space for a collection vehicle is limited. The compactor is built into the same door through which the compacted refuse is later emptied, eliminating the need for the additional space required for the time-consuming double "turn-around" maneuver required for conventional self-contained models.

## RJ-88SC Self Contained Compactor

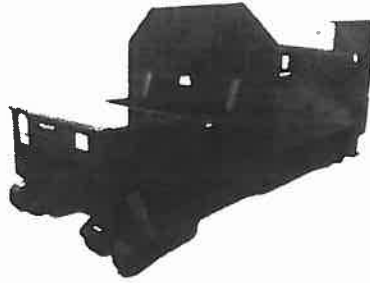

[ [Specifications](#) | [Literature](#) | [Operational & Steel Options](#) ]

Marathon's **RJ-88SC Self-Contained Compactor/ Containers** are ideal for waste with high liquid content and for applications where space is limited. Each RJ-88 series compactors store liquid and controls insect and odor problems.

### RJ-250SC Features:

#### The RJ-88SC is ideal for...

Shopping Centers

Supermarkets

Restaurants

Hotels

Inflight Kitchens

Hospitals and institutions

Components are selected for longevity and minimum maintenance, with special attention given to the selection of highly sensitive components. Stress engineering provides the optimum degree of structural integrity. Only the best materials are used. The highest standards of quality are observe in the manufacturing process. That's why you'll find Marathon Compactors "packing trash" long after other makes have failed!

The **RJ-88 SC's** smaller size makes it excellent for restaurant and fast food applications. They normally fit easily in waste corrals for an attractive and convenient installation at minimum installation cost.

With standard double end pick-up, the unit can be loaded for hauling from either end. This is especially useful if installed perpendicular to a dock (Packer End pick-up option does not include front ground rollers).

The RJ-88 SC uses a **Remote Power Pack** that remains on-site while the self-contained compactor container is taken to the landfill.

Factory testing to assure leakproof construction.



*The RJ-250SC uses a Remote Power Pack that remains on-site while the self-contained compactor container is taken to the landfill.*



**Also See the RJ-88 HT.** The RJ-88 HT features a Hydraulic Tailgate and is well suited for security chute-fed and dock-fed applications where maneuvering space for the collection vehicle is limited.

The RJ-88 Series Self-Contains can be used with a hopper to double or triple your loading capacity!

They are equally easy to load from ground or dock level and can be continuously fed while the unit is cycling!

Total odor and pest control via Marathon's **Ozone Odor Control option**

Easy and fast installation! Installation costs are cut by half over conventional compaction systems.

Fire hose connection provided on each unit.

**RJ-88C Compactors can be customized with a variety of loading arrangements to suit your specific needs.**



**Marathon's RJ-88SC Self Contained Compactor is UL Listed!**

**Features & Benefits of Marathon's Self-Contained Wet Waste Compaction Equipment:**

Marathon's **CYCON Life-Xtender® Cyclic Control System:** eliminates troublesome limit and pressure cycle control switches. It also reduces trash removal cost by producing superior payloads and dramatically improving cold weather performance.

Marathon's compactors meet all of ANSI and OSHA standards.

Each unit is **UL Listed** to assure quality and maintains the highest industry standards (does not apply to GreenBuilt).

Standard **double end pick-up** (except HT models) which allows the unit to be loaded for hauling from either end. This is especially useful if the self-contained unit is perpendicular to a dock.

Through-the-wall feed chutes offer convenience to employees that reduces labor cost and improves security.

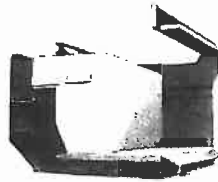

The **Qwik Clean Tank®** funnels any liquid seepage during compaction into an enclosed area underneath the charge box floor. The liquid is automatically discharged at the disposal site, in effect flushing the container and the area behind the ram.



Rear door retains wet waste effectively with its patented **"Double-Hinge"** and custom designed **"P" Seal**.



The innovative **"Bubble Gate"** adds a cubic yard to the container capacity. Its curved shape also produces superior compaction ratios.

**Specifications:**

RJ-88 SC Self-Contained

**RJ-88SC Specifications**

Dimension	A*	B	C	D	E	Weight
15 cu yds	43"	30 1/2"	70"	187"	89"	7200 lbs.
	1092mm	777mm	1778mm	4750mm	2261mm	3265 kg.
20 cu yds	43"	30 1/2"	70"	222"	89"	7600 lbs.
	1092mm	777mm	1778mm	5639mm	2261mm	3447 kg.
24 cu yds	43"	30 1/2"	70"	256"	89"	8000 lbs.
	1092mm	777mm	1778mm	6502mm	2261mm	3628 kg.

**Charge Box Capacity**

[Mfr's. Rating]	1.0 cy	.76 m <sup>3</sup>
[WASTECH Rating]	0.70 cy	.54 m <sup>3</sup>
Clear Top Opening	30.5" L X 48" W	775mm x 1219mm

**Performance Data:**

Cycle Time	44 sec	44 sec
Total Normal Force	36,600 lb	162 kN
Total Maximum Force	43,100 lb	192 kN
Normal Ram Face Pressure	34.7 psi	239 kPa
Maximum Ram Face Pressure	40.8 psi	281 kPa
Ram Penetration	60	152 mm

**Electrical Equipment**

Electric Motor 3/60/230-460	5 hp	3.7 kW
Electric Control Voltage	120 VAC	120 VAC
Panel Box Assembly UL Listed		
All Circuits Fused Key Operated		
3 Push Button Station Start/Stop/Reverse		

**Hydraulic Equipment**

Hydraulic Pump	6 gpm	23 L/min
Normal Pressure	1700 psi	117 bar
Maximum Pressure	2000 psi	138 bar
Cylinder Bore	2 @ 4" each	102 mm
Cylinder Rod	2 @ 2.5"	64 mm

**Optional Features:**

**TrashMinder®**



The optional **TrashMinder®** is the most advanced method for reporting and measuring container fullness as well as for managing user access and billing. **Get More Details.**

**The StreamLine® Option**



allows excess liquid to be drained from the container reducing net payload weight and significantly reducing hauling costs! Liquid is routed to four interconnected 4" drain

### Qwik Clean Door®



The innovative Qwik Clean Door provides access to the area behind the ram of self-contained compactors. It allows for quick, easy cleaning and other routine

maintenance without having to unbolt panels or break welds. The Qwik Clean Door features our Auto-Relatch to hold the door closed while the door is being ratcheted and our patented "P" Seal for a tight, leak proof seal.

Pictures on this page are illustrative only. Specifications are subject to change without notice to accommodate improvements to the equipment. Certified in compliance with ANSI Regulation

Z245.2, all OSHA standards, and certified under WASTEC's Stationary Compactor Certification Program. Products must be used with safe practice and in accordance with said regulations and standards.

outlets located at each corner of the StreamLine unit. Connection can be made to a hose, piping, or pump.

**See how the StreamLine System works.**

### Cart Dumpers



Your Self-Contained can be fitted with various configurations of cart dumper systems. Other options include: multi-cycle timer, dual controls, ozone odor control system, security chutes, hoppers,

and many much more.

**Top of Page**

Bill Of Material		
Ref. No.	Qty.	Cat. No.
		Material

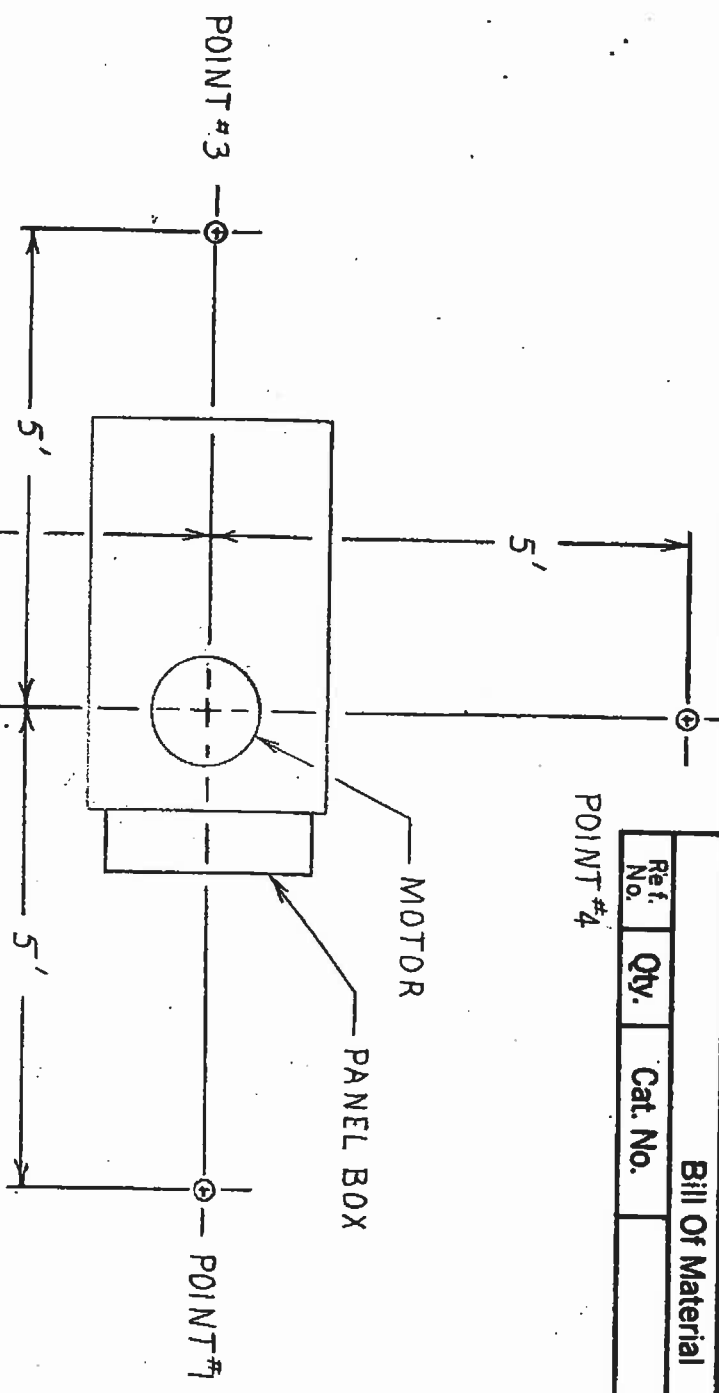

POINT	DECIBEL UNIT 1	READINGS * UNIT 2
1	76	77
2	78	75
3	75	77
4	77	75

TWO POWER UNITS TESTED  
 \*ALL READINGS "A" WEIGHTED & "SLOW" RESPONSE

# RAMJET

Equipment Company,

Vernon, Alabama 35592

Title: DECIBEL READINGS RT-88 SC  
 POWER UNIT

Drawn: RB

Date: 1-5-89

Drawing Number:

51-45710

Routing:

Scale: NTS

Tolerances:

SHEET:

OF