

Framework Plan



Tribal Specific Spaces



Trails with Viewing Platforms



Market / Maker Spaces



Terraced, Multi-Family Residential

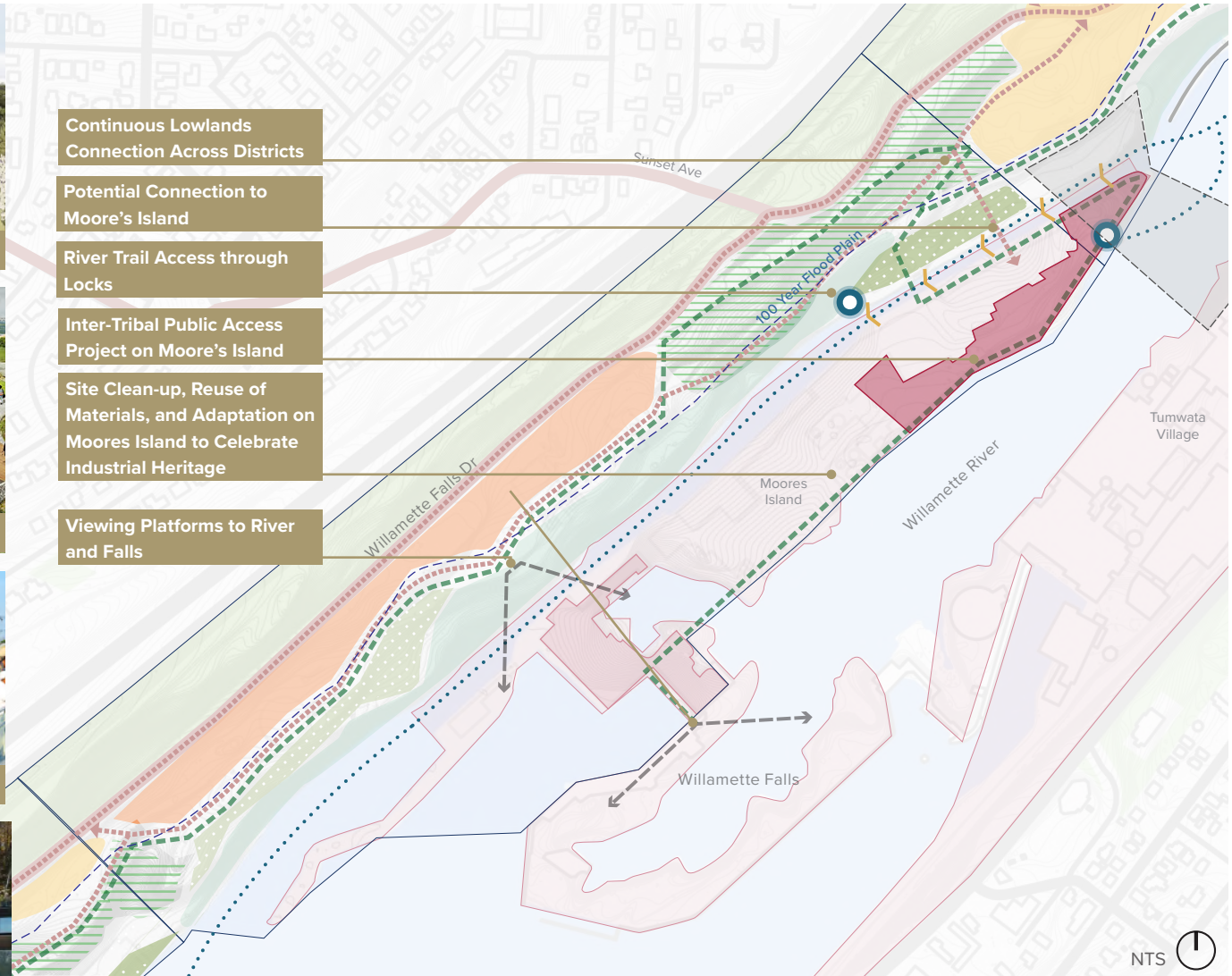

- Continuous Lowlands Connection Across Districts
- Potential Connection to Moore's Island
- River Trail Access through Locks
- Inter-Tribal Public Access Project on Moore's Island
- Site Clean-up, Reuse of Materials, and Adaptation on Moores Island to Celebrate Industrial Heritage
- Viewing Platforms to River and Falls

- | | | |
|----------------------------------|--|------------------------|
| Parks/Open Space | Potential Development Area | Waterfront Trail |
| Steep and/or Sloped Green Buffer | Existing Streets / Connections | Willamette River Trail |
| Steep/Dense Wooded Area | Multimodal Greenway | River Access Point |
| Historic and/or Cultural Asset | Potential New Street / Connection | Locks |
| | ODOT Bike/Pedestrian Bridge Alignment Option | |

Proposed programs and circulation ideas are conceptual and will require further study and coordination with property owners. Zoning changes may be required to allow for proposed programs / compatible uses. Willamette Falls Drive alignment reflects alignment currently adopted in West Linn Transportation System Plan (TSP). The Federal Energy Regulatory Commission (FERC) sets a boundary to secure the power production functions of the T.W. Sullivan hydroelectric plant. There are restrictions on the access and uses allowed within the FERC boundary. Low-impact projects, such as trails, streets, and public access to the shoreline, may be acceptable; however, a more detailed assessment in consultation with FERC and PGE will be required.