



City of West Linn, Oregon

Mapleton Sewer Rehabilitation Project

Phase 3: Zones 4 and 5

Project Number: PW1214

September 2012

Index of Drawings:

GENERAL

- 1 G-1 COVER SHEET, INDEX OF DRAWINGS AND LOCATION MAP
- 2 G-2 SANITARY SEWER DRAWING INDEX MAP
- 3 G-3 SANITARY SEWER NOTES AND DETAILS

SANITARY SEWER

- 4 SS-1 ZONE 4: HILLCREST CT, RYDMAN CT, VIEW DR
- 5 SS-2 ZONE 4: HILLCREST CT, CONNECTION TO SUN CIR, WILDWOOD DR, AND ZONE 5
ZONE 5: VALLEY VIEW DR, WOODHAVEN CT
- 6 SS-3 ZONE 4: SUN CIR, WILDWOOD DR
ZONE 5: PARKVIEW CT, VALLEY CT, WOODHAVEN CT
- 7 SS-4 ZONE 4: CARRIAGE WAY, SUN CIR, WILDWOOD DR
- 8 SS-5 ZONE 4: SUNBURST TER, SUNCREST DR
- 9 SS-6 ZONE 5: PARKVIEW CT, RIDGEBROOK DR, SUNCREST DR, VALLEY CT, VALLEY VIEW DR
- 10 SS-ALT-1 ALTERNATE NO1: KAPTEYNS ST
- 11 SS-ALT-2 ALTERNATE NO2: MARYLHURST CIR
- 12 SS-ALT-3 ALTERNATE NO3: SUNSET AVE

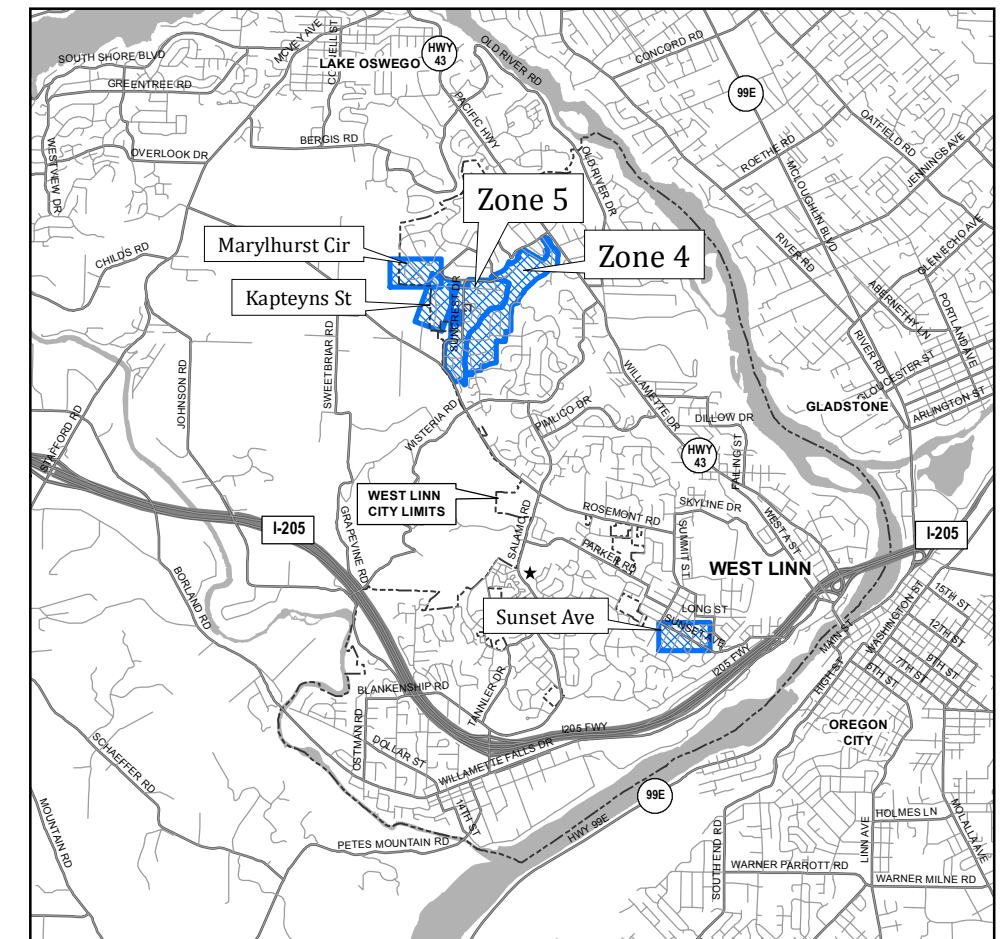

LOCATION MAP
NOT TO SCALE

ATTENTION: OREGON LAW REQUIRES YOU TO FOLLOW RULES ADOPTED BY THE OREGON UTILITY NOTIFICATION CENTER. THOSE RULES ARE SET FORTH IN OAR 952-001-0010 THROUGH OAR 952-001-0090. YOU MAY OBTAIN COPIES OF THE RULES BY CALLING THE CENTER. (NOTE: THE TELEPHONE NUMBER FOR THE OREGON UTILITY NOTIFICATION CENTER IS (503) 232-1987



City of West Linn, Oregon
Mapleton Sewer Rehabilitation Project
Phase3: Zones 4 and 5
PW1214

This product is for informational purposes and may not have been prepared for, or be suitable for legal, engineering, or surveying purposes. Users of this information should review or consult the primary data and information sources to ascertain the usability of the information.

SHEET
G-1
1 OF 12
PUBLISHED 9/4/2012

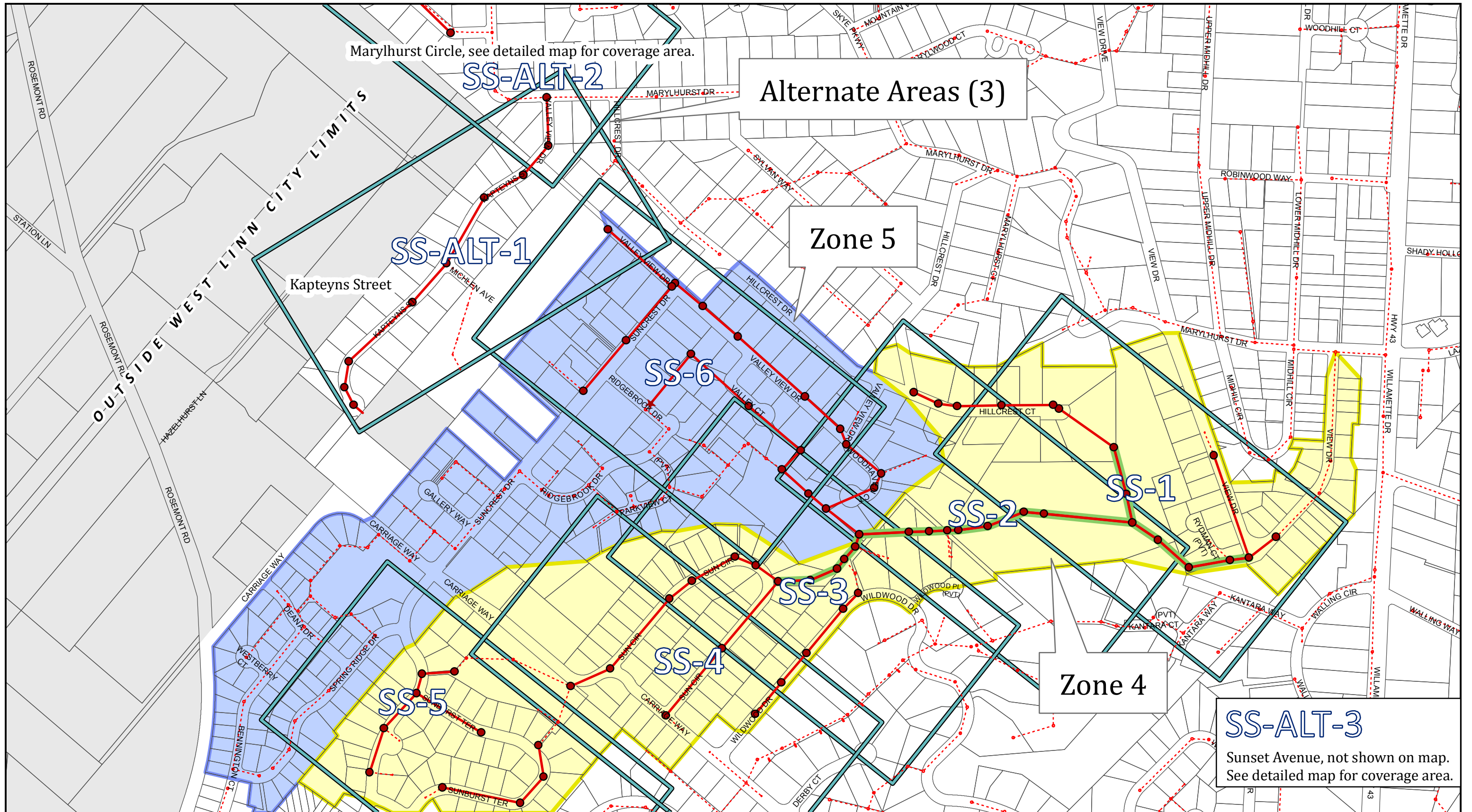

City of West Linn, Oregon
 Mapleton Sewer Rehabilitation Project
 Phase 3: Zones 4 and 5
 PW1214

Map Index
Note:
 KEY MAP IS PROVIDED AS AN INDEX FOR THE PLAN SHEET LAYOUT ONLY AND DOES NOT IDENTIFY WORK OR MATERIALS REQUIRED FOR CONSTRUCTION

Project Zones 4 & 5
 Zone 4
 Zone 5

- Manhole
- ★ Clean Out
- Sewer Mains Inside Project Area
- Condition Unknown (See Contract)

- Other Sewer Mains
 - Sheet Layout
 - Taxlot Lines
- Taxlot Base Source: Clackamas County
 Utility Map Overlays: West Linn
 Geographic Information Systems

This product is for informational purposes and may not have been prepared for, or be suitable for legal, engineering, or surveying purposes. Users of this information should review or consult the primary data and information sources to ascertain the usability of the information.

1 Inch = 400 Feet
 0 100 200 400 Feet
 IF THIS BAR DOES NOT MEASURE 1" THEN THIS DRAWING IS NOT TO SCALE

SHEET G-2
 2 OF 12
 PUBLISHED 9/4/2012

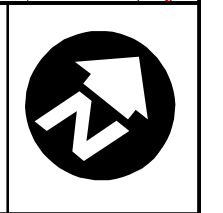

General Notes:

1. ALL CONSTRUCTION SHALL BE IN ACCORDANCE WITH DEQ, OREGON STATE HEALTH DEPARTMENT, AND THE CITY OF WEST LINN STANDARD CONSTRUCTION SPECIFICATIONS, AS APPLICABLE.
2. THE LOCATIONS OF ALL EXISTING UNDERGROUND FACILITIES SHOWN ON THE PLANS ARE BASED ON INFORMATION PROVIDED BY THE CITY OF WEST LINN AND INFORMATION SUPPLIED BY UTILITY COMPANIES. LOCATIONS ARE NOT GUARANTEED TO BE COMPLETE OR ACCURATE. THE CONTRACTOR SHALL VERIFY LOCATIONS, ELEVATIONS, TYPE AND SIZES OF ALL EXISTING UTILITIES PRIOR TO CONSTRUCTING NEW PIPING/CONDUITS AND SHALL ADJUST NEW PIPING/CONDUITS AS REQUIRED. CONTRACTOR SHALL NOTIFY THE CITY PROJECT MANAGER IMMEDIATELY OF ANY CONFLICTS NOT SHOWN ON THE PLANS AND SHALL KEEP EXISTING UTILITIES IN SERVICE AND PROTECT THEM DURING CONSTRUCTION, WHERE INTERRUPTION OF EXISTING FACILITIES IS REQUIRED, CONTRACTOR SHALL PROVIDE 72 HOUR NOTICE TO THE CITY PROJECT MANAGER AND THE AFFECTED UTILITY, CONTRACTOR SHALL ARRANGE FOR THE RELOCATION OF ANY IN CONFLICT WITH THE PROPOSED CONSTRUCTION.
3. THE CONTRACTOR SHALL DISPOSE OF ALL REMOVED OR REPLACED MATERIAL AND EQUIPMENT IN ACCORDANCE WITH ALL APPLICABLE REGULATIONS, EXCEPT THOSE ITEMS DESIGNATED BY THE OWNER FOR SALVAGING, SALVAGED ITEMS SHALL REMAIN THE PROPERTY OF THE OWNER, AND SHALL BE CAREFULLY REMOVED AND STORED AS DIRECTED.
4. CONTRACTOR TO LEAVE ALL AREAS OF PROJECT FREE OF DEBRIS AND UNUSED CONSTRUCTION MATERIAL.
5. ANY ALTERATION OR VARIANCE FROM THESE PLANS, EXCEPT MINOR FIELD ADJUSTMENT NEEDED TO MEET EXISTING FIELD CONDITIONS, SHALL FIRST BE APPROVED BY THE CITY PROJECT MANAGER. ANY ALTERATIONS OR VARIANCE FROM THESE PLANS SHALL BE DOCUMENTED ON CONSTRUCTION FIELD PRINTS AND TRANSMITTED TO THE CITY PROJECT MANAGER. ANY PROPOSED CHANGES IN CONSTRUCTION PLANS MUST BE SUBMITTED IN WRITING AND APPROVED BY THE CITY PROJECT MANAGER PRIOR TO COMMENCING WORK.
6. CONTRACTOR SHALL KEEP AND MAINTAIN A CURRENT SET OF DRAWINGS ON SITE. CONTRACTOR TO KEEP ACCURATE "AS-BUILT" RECORD COPY OF PLANS. "AS-BUILT" PLANS TO BE RETURNED TO THE CITY PROJECT MANAGER AT COMPLETION OF PROJECT.
7. A PRE-CONSTRUCTION MEETING WITH THE CITY AND THE CONTRACTOR IS REQUIRED PRIOR TO THE START OF CONSTRUCTION.
8. THE CITY PROJECT MANAGER SHALL BE SUPPLIED WITH MATERIAL CERTIFICATIONS FOR ALL MATERIALS USED ON PUBLIC INFRASTRUCTURE.
9. MANDATORY PRE-BID MEETING PER BID DOCUMENTS.
10. CONTRACTOR SHALL OBTAIN ALL NECESSARY LOCAL, COUNTY, STATE, AND UTILITY CONSTRUCTION PERMITS, AND SHALL CONTACT EACH PERMITTING AGENCY AT LEAST TWO (2) BUSINESS DAYS PRIOR TO STARTING WORK. CONTRACTOR SHALL OBTAIN ALL REQUIRED LICENSES BEFORE STARTING CONSTRUCTION.

11. THE CONTRACTOR SHALL COMPLY WITH ALL REQUIREMENTS OF ORS 757.541 TO 757.571. THE CONTRACTOR SHALL NOTIFY EACH UNDERGROUND UTILITY AT LEAST 48 BUSINESS-DAY HOURS, BUT NOT MORE THAN 10 BUSINESS DAYS, PRIOR TO EXCAVATING, BORING, OR POTHOLING.
12. NO ADDITIONAL PAYMENT SHALL BE MADE FOR UTILITY RELOCATION COORDINATION OR DELAYS CAUSED BY UTILITY CONFLICTS. ALL COSTS RELATED TO UTILITY COORDINATION AND RELOCATION, INCLUDING ADDITIONAL POTHOLING, ARE TO BE CONSIDERED INCIDENT AND INCLUDED IN THE UNIT PRICES OF THE BID.
13. UTILITIES OR INTERFERING PORTIONS OF UTILITIES THAT ARE ABANDONED IN PLACE SHALL BE REMOVED BY THE CONTRACTOR TO THE EXTENT NECESSARY TO ACCOMPLISH THE WORK. THE CONTRACTOR SHALL PLUG THE REMAINING EXPOSED ENDS OF ABANDONED UTILITIES, UNLESS OTHERWISE REQUIRED BY THE ENGINEER.
14. CONTRACTOR SHALL INSTALL AND MAINTAIN EROSION AND SEDIMENTATION CONTROL DURING CONSTRUCTION (ANY TIME OF YEAR) PER THE REQUIREMENTS OF THE CITY OF WEST LINN, CLACKAMAS COUNTY AND THE OREGON DEQ.
15. ALL CONSTRUCTION AND MATERIALS SHALL CONFORM TO THE PLANS AND PROJECT SPECIFICATIONS.
16. CONTRACTOR SHALL NOTIFY THE RESIDENTS AT EACH ADDRESS A MINIMUM OF 48 HOURS IN ADVANCE TO COMMENCEMENT OF WORK AND AGAIN IMMEDIATELY PRIOR TO THE DISRUPTION OF THEIR SERVICE.
17. CONTRACTOR SHALL NOTIFY THE CITY PROJECT MANAGER AND OWNER 48 HOURS BEFORE STARTING CONSTRUCTION, AND 24 HOURS BEFORE RESUMING WORK AFTER SHUTDOWNS EXCEPT FOR NORMAL RESUMPTION OF WORK FOLLOWING SATURDAYS, SUNDAYS, OR HOLIDAYS. CONTRACTOR SHALL NOTIFY THE OWNER'S REPRESENTATIVE A MINIMUM OF 48 HOURS PRIOR TO ANY TESTING OR REQUIRED INSPECTION.
18. CONTRACTOR SHALL PROTECT ALL PROPERTY CORNERS, SURVEY MONUMENTS AND CONTROL POINTS. SURVEY MONUMENTS OF THIS TYPE DISTURBED DURING CONSTRUCTION SHALL BE REPLACED AT CONTRACTOR'S EXPENSE, WITH APPROPRIATE SURVEYS FILED WITH THE COUNTY SURVEYOR.
19. ALL STRUCTURES, LOTS, SWALES, DITCHES, CURBS, SPEED BUMPS, FENCES, WALLS, MAILBOXES, SIGNS, POLES, GUY WIRES, PIPING, AND UTILITIES DISTURBED DURING CONSTRUCTION TO BE RESTORED TO EXISTING CONDITION UNLESS OTHERWISE SPECIFIED. SUCH REPAIR SHALL BE CONSIDERED INCIDENTAL.
20. CONTRACTOR SHALL PROTECT TRAFFIC AT ALL TIMES DURING CONSTRUCTION. ALL TRAFFIC CONTROL MEASURES SHALL BE APPROVED BY CITY, COUNTY AND STATE AS REQUIRED AND IN PLACE PRIOR TO ANY CONSTRUCTION ACTIVITIES. THE CONTRACTOR SHALL PROVIDE TRAFFIC CONTROL PLANS TO THE CITY PROJECT MANAGER PRIOR TO COMMENCING ANY WORK WITHIN THE PUBLIC RIGHT-OF-WAY. SEE SPECIAL PROVISIONS SECTION IN THE TECHNICAL SPECIFICATIONS FOR DETAILS.

Sewer Slipline Notes:

1. DO NOT SLIP LINE THE TWO INCH PRESSURIZED SEWER MAIN ON MARYLHURST CIRCLE
2. DO NOT SLIPLINE ANY SEWER MAIN THAT DOES NOT BEGIN OR TERMINATE IN A MANHOLE



City of West Linn, Oregon
 Mapleton Sewer Rehabilitation Project
 Phase 3: Zones 4 and 5
 PW1214

This product is for informational purposes and may not have been prepared for, or be suitable for legal, engineering, or surveying purposes. Users of this information should review or consult the primary data and information sources to ascertain the usability of the information.

SHEET
G-3
 3 OF 12

PUBLISHED 9/4/2012

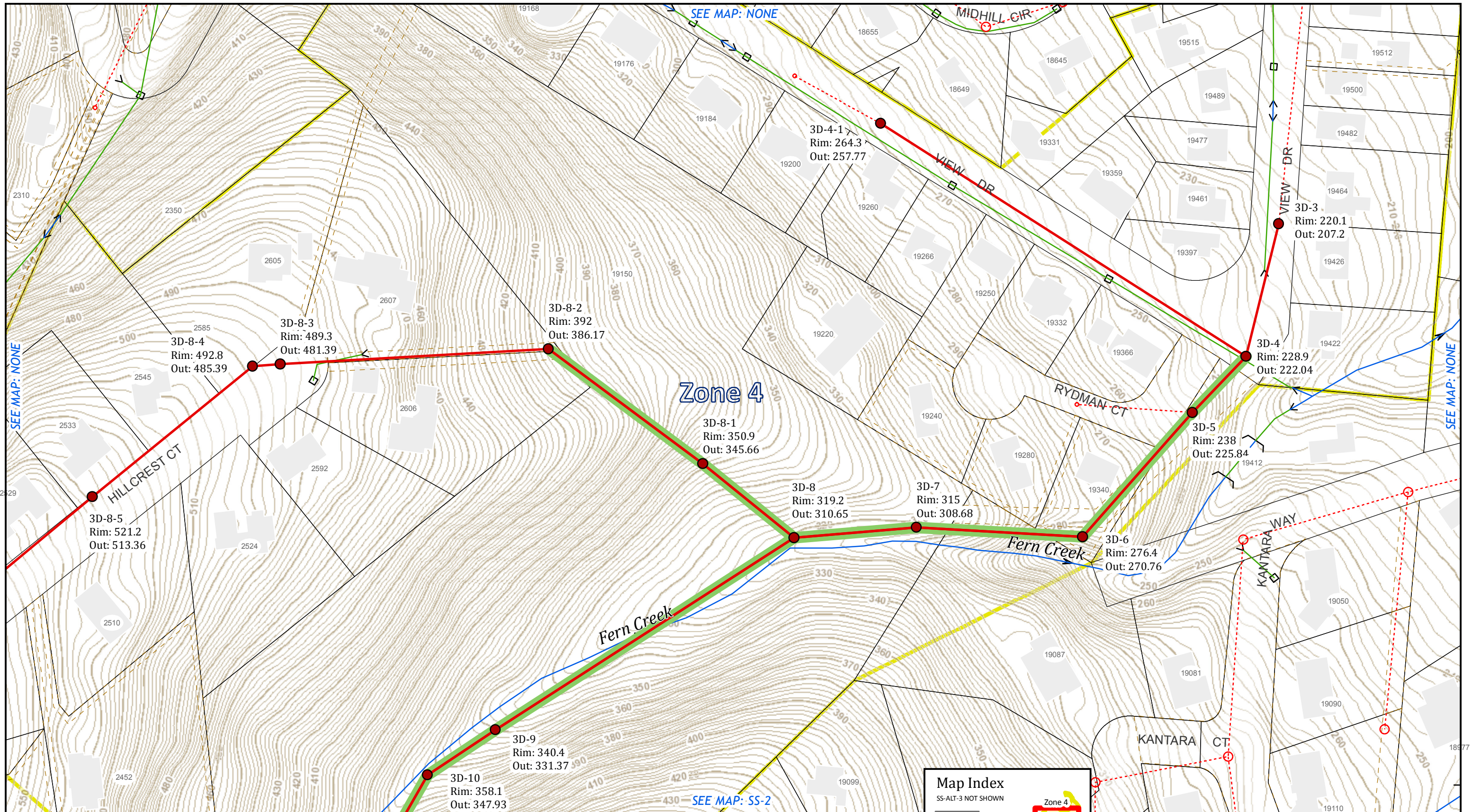

City of West Linn, Oregon
 Mapleton Sewer Rehabilitation Project
 Phase 3: Zones 4 and 5
 PW1214

Key Notes:
 A. CONTRACTOR TO INSTALL CIPP (CURED IN PLACE PIPE) LINER IN ALL OF THE SANITARY SEWER MAINS HIGHLIGHTED IN THE PLAN VIEW
 B. CONTRACTOR TO RECONNECT ALL ACTIVE LATERALS. CONTRACTOR TO CONFIRM STATUS OF LATERALS PRIOR TO INSTALLATION OF CIPP.
 C. CONTRACTOR TO REMOVE ALL PROTRUDING LATERALS AND ROOT INTRUSIONS PRIOR TO CIPP INSTALLATION.

- Manhole Inside Project Area
 - ★ Clean Out Inside Project Area
 - Sewer Mains Inside Project Area
 - Condition Unknown (See Contract) Shown on maps SS-1, SS-2, and SS-3 only
 - - - Other Sewer Mains
 - Zone 4 Outline
 - Zone 5 Outline
 - 2840 Taxlot Lines & Address Numbers
 - Buildings
 - Known Easements
 - 2-Foot Interval Contours
 - Outside West Linn City Limits
 - Storm Pipes
 - Storm Open Channel
- Taxlot Base Source: Clackamas County, Utility Map Overlays: West Linn GIS

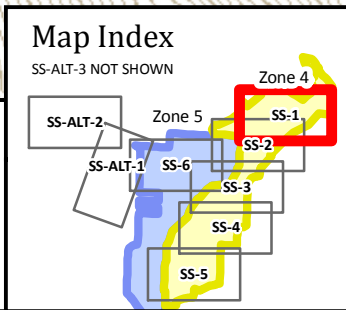

This product is for informational purposes and may not have been prepared for, or be suitable for legal, engineering, or surveying purposes. Users of this information should review or consult the primary data and information sources to ascertain the usability of the information.

1 Inch = 100 Feet

0 25 50 100 Feet

IF THIS BAR DOES NOT MEASURE 1" THEN THIS DRAWING IS NOT TO SCALE

SHEET
SS-1
 4 OF 12

PUBLISHED 9/4/2012

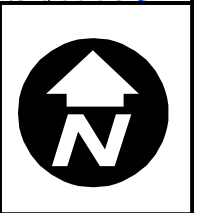

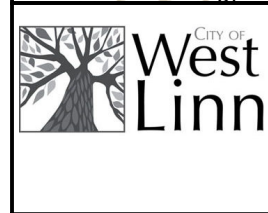
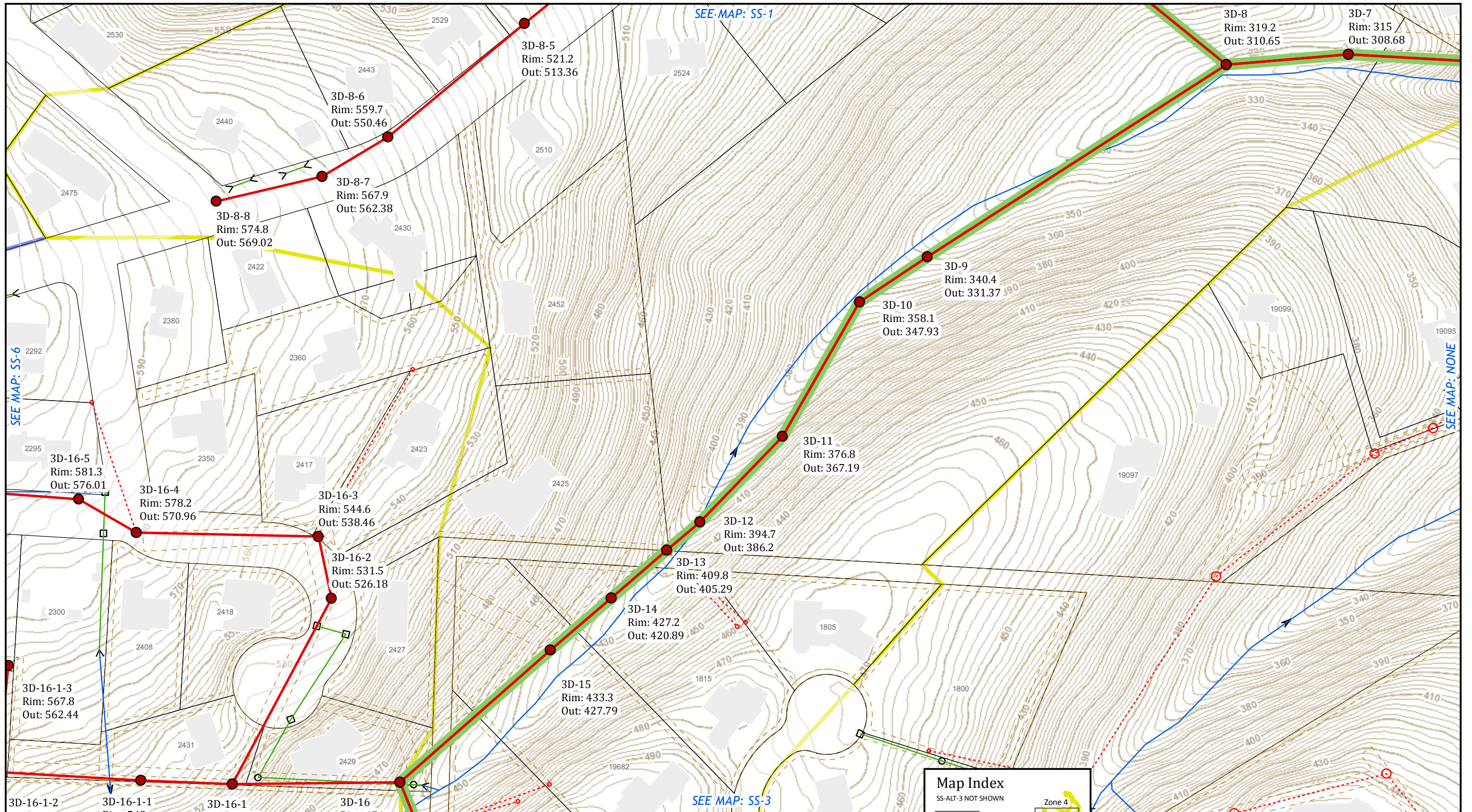

City of West Linn, Oregon
 Mapleton Sewer Rehabilitation Project
 Phase 3: Zones 4 and 5
 PW1214

Key Notes:
 A. CONTRACTOR TO INSTALL CIPP (CURED IN PLACE PIPE) LINER IN ALL OF THE SANITARY SEWER MAINS HIGHLIGHTED IN THE PLAN VIEW
 B. CONTRACTOR TO RECONNECT ALL ACTIVE LATERALS. CONTRACTOR TO CONFIRM STATUS OF LATERALS PRIOR TO INSTALLATION OF CIPP.
 C. CONTRACTOR TO REMOVE ALL PROTRUDING LATERALS AND ROOT INTRUSIONS PRIOR TO CIPP INSTALLATION.

- Manhole Inside Project Area
 - ★ Clean Out Inside Project Area
 - Sewer Mains Inside Project Area
 - Condition Unknown (See Contract) Shown on maps SS-1, SS-2, and SS-3 only
 - - - Other Sewer Mains
 - Zone 4 Outline
 - Zone 5 Outline
 - Taxlot Lines & Address Numbers
 - Buildings
 - - - Known Easements
 - - - 2-Foot Interval Contours
 - Outside West Linn City Limits
 - Storm Pipes
 - Storm Open Channel
- Taxlot Base Source: Clackamas County, Utility Map Overlays: West Linn GIS

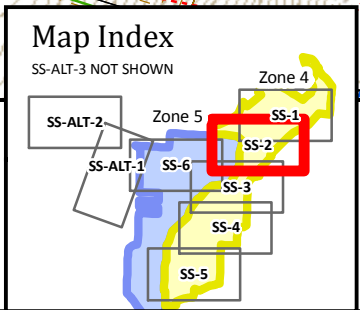

This product is for informational purposes and may not have been prepared for, or be suitable for, legal, engineering, or surveying purposes. Users of this information should review or consult the primary data and information sources to ascertain the usability of the information.

1 Inch = 100 Feet

0 25 50 100 Feet

IF THIS BAR DOES NOT MEASURE 1" THEN THIS DRAWING IS NOT TO SCALE

SHEET
 SS-2
 5 OF 12
 PUBLISHED 9/4/2012

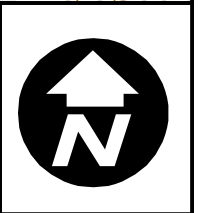

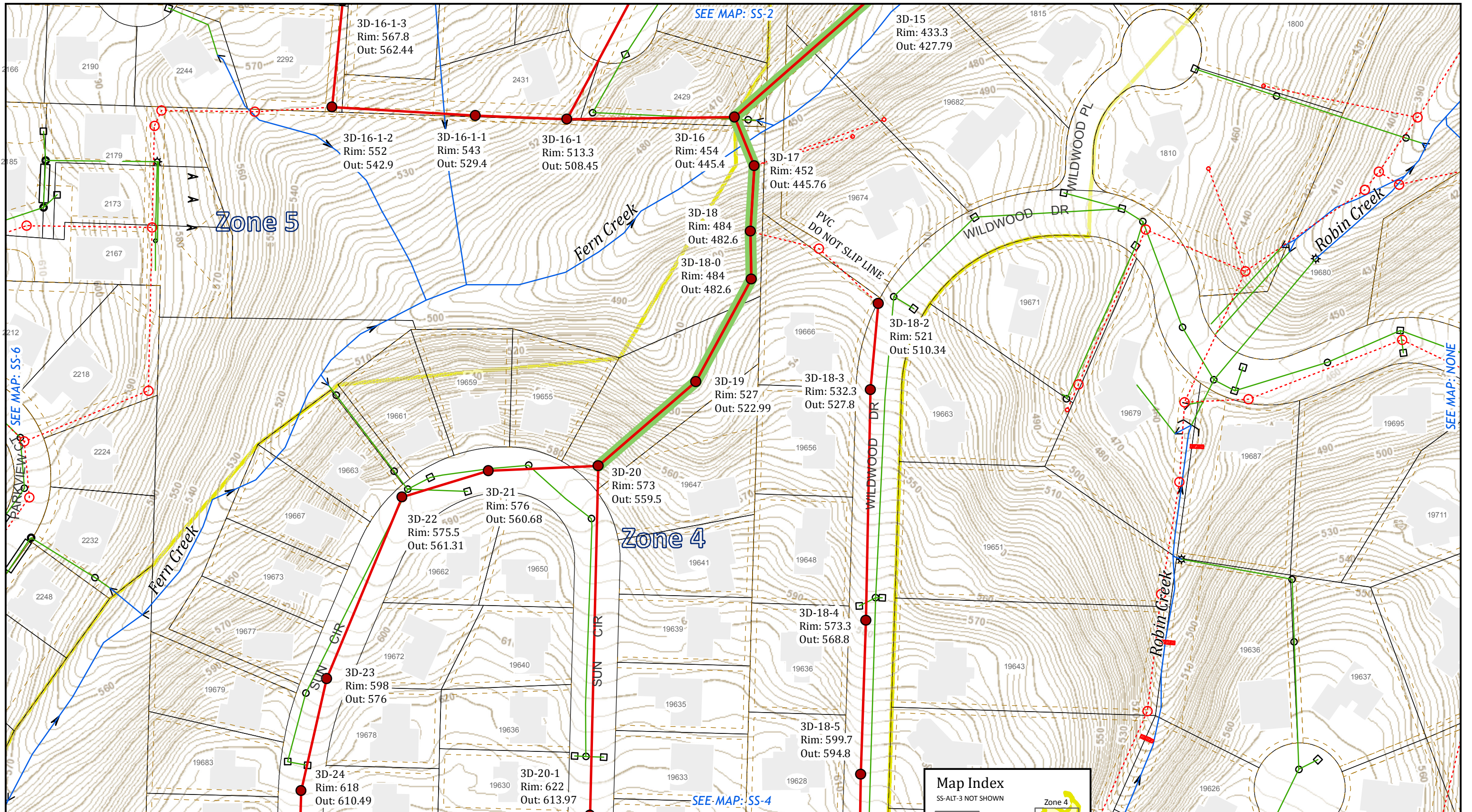

City of West Linn, Oregon
 Mapleton Sewer Rehabilitation Project
 Phase 3: Zones 4 and 5
 PW1214

Key Notes:
 A. CONTRACTOR TO INSTALL CIPP (CURED IN PLACE PIPE) LINER IN ALL OF THE SANITARY SEWER MAINS HIGHLIGHTED IN THE PLAN VIEW
 B. CONTRACTOR TO RECONNECT ALL ACTIVE LATERALS. CONTRACTOR TO CONFIRM STATUS OF LATERALS PRIOR TO INSTALLATION OF CIPP.
 C. CONTRACTOR TO REMOVE ALL PROTRUDING LATERALS AND ROOT INTRUSIONS PRIOR TO CIPP INSTALLATION.

- Manhole Inside Project Area
- ★ Clean Out Inside Project Area
- Sewer Mains Inside Project Area
- Condition Unknown (See Contract) Shown on maps SS-1, SS-2, and SS-3 only
- - - Other Sewer Mains
- ▭ Zone 4 Outline
- ▭ Taxlot Lines & Address Numbers
- ▭ Buildings
- - - Known Easements
- - - 2-Foot Interval Contours
- ▭ Outside West Linn City Limits
- ▭ Utility Map Overlays: West Linn GIS
- ▭ Zone 5 Outline
- ▭ Storm Pipes
- ▭ Storm Open Channel

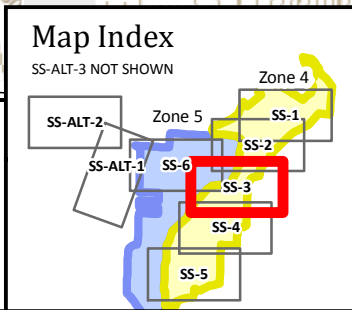

This product is for informational purposes and may not have been prepared for, or be suitable for legal, engineering, or surveying purposes. Users of this information should review or consult the primary data and information sources to ascertain the usability of the information.

1 Inch = 100 Feet

0 25 50 100 Feet

IF THIS BAR DOES NOT MEASURE 1" THEN THIS DRAWING IS NOT TO SCALE

SHEET
SS-3
 6 OF 12
 PUBLISHED 9/5/2012

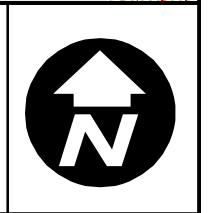

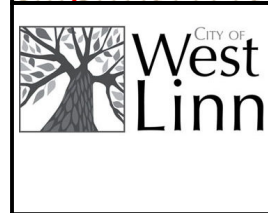

City of West Linn, Oregon
 Mapleton Sewer Rehabilitation Project
 Phase 3: Zones 4 and 5
 PW1214

Key Notes:
 A. CONTRACTOR TO INSTALL CIPP (CURED IN PLACE PIPE) LINER IN ALL OF THE SANITARY SEWER MAINS HIGHLIGHTED IN THE PLAN VIEW
 B. CONTRACTOR TO RECONNECT ALL ACTIVE LATERALS. CONTRACTOR TO CONFIRM STATUS OF LATERALS PRIOR TO INSTALLATION OF CIPP.
 C. CONTRACTOR TO REMOVE ALL PROTRUDING LATERALS AND ROOT INTRUSIONS PRIOR TO CIPP INSTALLATION.

- Manhole Inside Project Area
 - ★ Clean Out Inside Project Area
 - Sewer Mains Inside Project Area
 - Condition Unknown (See Contract) Shown on maps SS-1, SS-2, and SS-3 only
 - - - Other Sewer Mains
 - Zone 4 Outline
 - Zone 5 Outline
 - Taxlot Lines & Address Numbers
 - Buildings
 - Known Easements
 - 2-Foot Interval Contours
 - Outside West Linn City Limits
 - Storm Pipes
 - Storm Open Channel
- Taxlot Base Source: Clackamas County, Utility Map Overlays: West Linn GIS

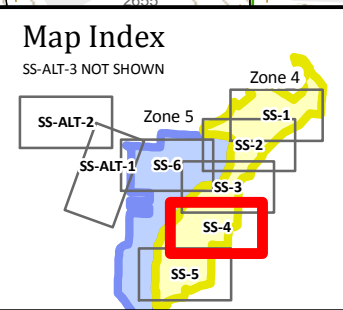

This product is for informational purposes and may not have been prepared for, or be suitable for legal, engineering, or surveying purposes. Users of this information should review or consult the primary data and information sources to ascertain the usability of the information.

1 Inch = 100 Feet

0 25 50 100 Feet

IF THIS BAR DOES NOT MEASURE 1" THEN THIS DRAWING IS NOT TO SCALE

SHEET
SS-4
7 OF 12
 PUBLISHED 9/4/2012

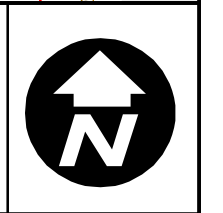

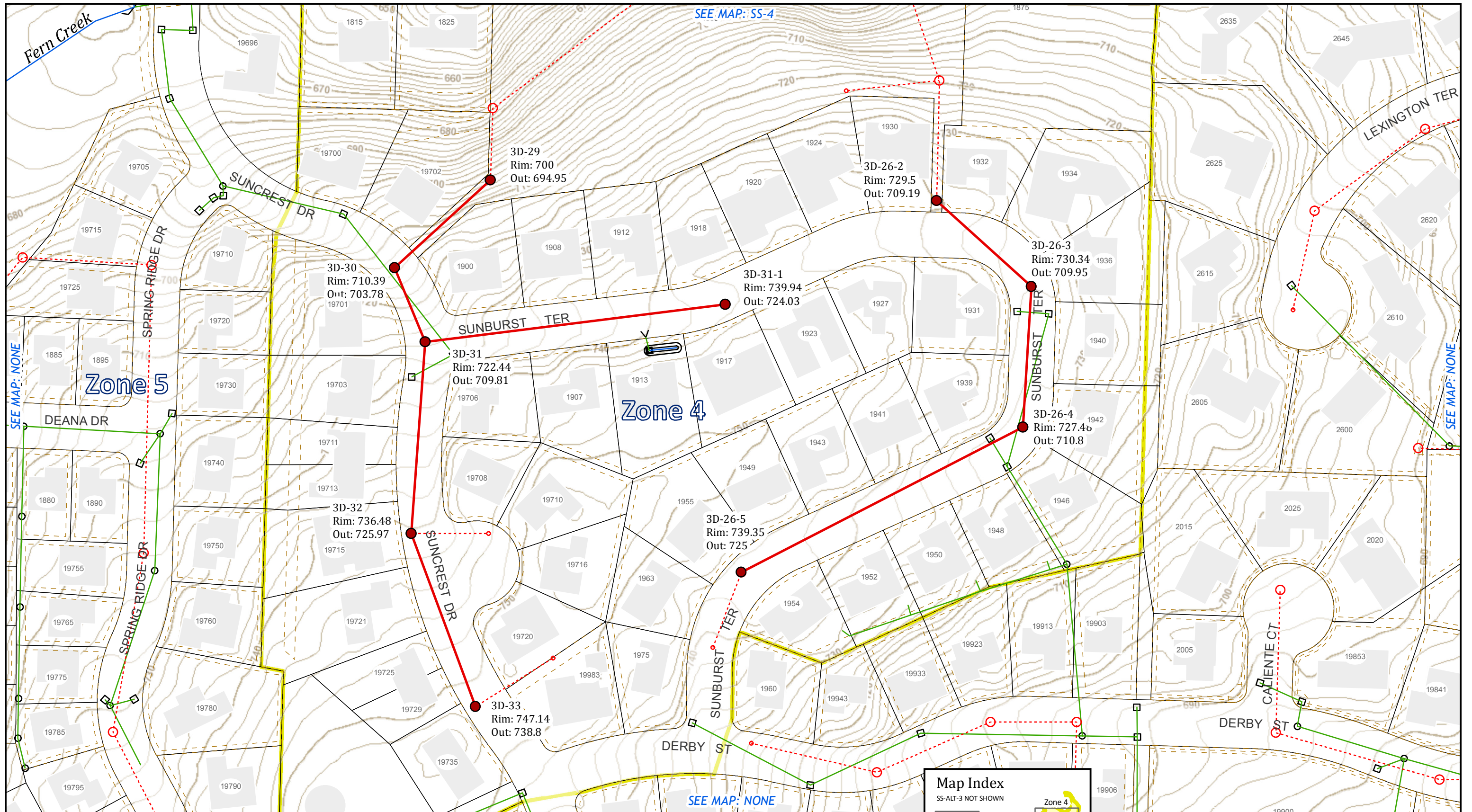

City of West Linn, Oregon
 Mapleton Sewer Rehabilitation Project
 Phase 3: Zones 4 and 5
 PW1214

Key Notes:
 A. CONTRACTOR TO INSTALL CIPP (CURED IN PLACE PIPE) LINER IN ALL OF THE SANITARY SEWER MAINS HIGHLIGHTED IN THE PLAN VIEW
 B. CONTRACTOR TO RECONNECT ALL ACTIVE LATERALS. CONTRACTOR TO CONFIRM STATUS OF LATERALS PRIOR TO INSTALLATION OF CIPP.
 C. CONTRACTOR TO REMOVE ALL PROTRUDING LATERALS AND ROOT INTRUSIONS PRIOR TO CIPP INSTALLATION.

- Manhole Inside Project Area
 - Clean Out Inside Project Area
 - Sewer Mains Inside Project Area
 - Condition Unknown (See Contract) Shown on maps SS-1, SS-2, and SS-3 only
 - Other Sewer Mains
 - Zone 4 Outline
 - Zone 5 Outline
 - Taxlot Lines & Address Numbers
 - Buildings
 - Known Easements
 - 2-Foot Interval Contours
 - Outside West Linn City Limits
 - Storm Pipes
 - Storm Open Channel
- Taxlot Base Source: Clackamas County, Utility Map Overlays: West Linn GIS

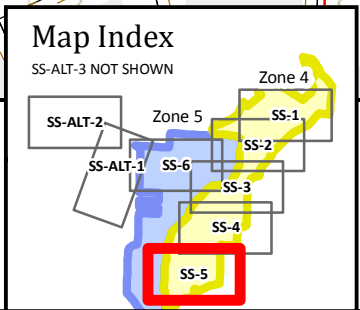

This product is for informational purposes and may not have been prepared for, or be suitable for, legal, engineering, or surveying purposes. Users of this information should review or consult the primary data and information sources to ascertain the usability of the information.

1 Inch = 100 Feet

IF THIS BAR DOES NOT MEASURE 1" THEN THIS DRAWING IS NOT TO SCALE

SHEET
SS-5
 8 OF 12
 PUBLISHED 9/4/2012

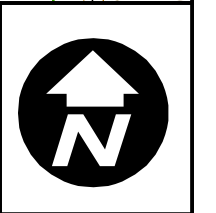

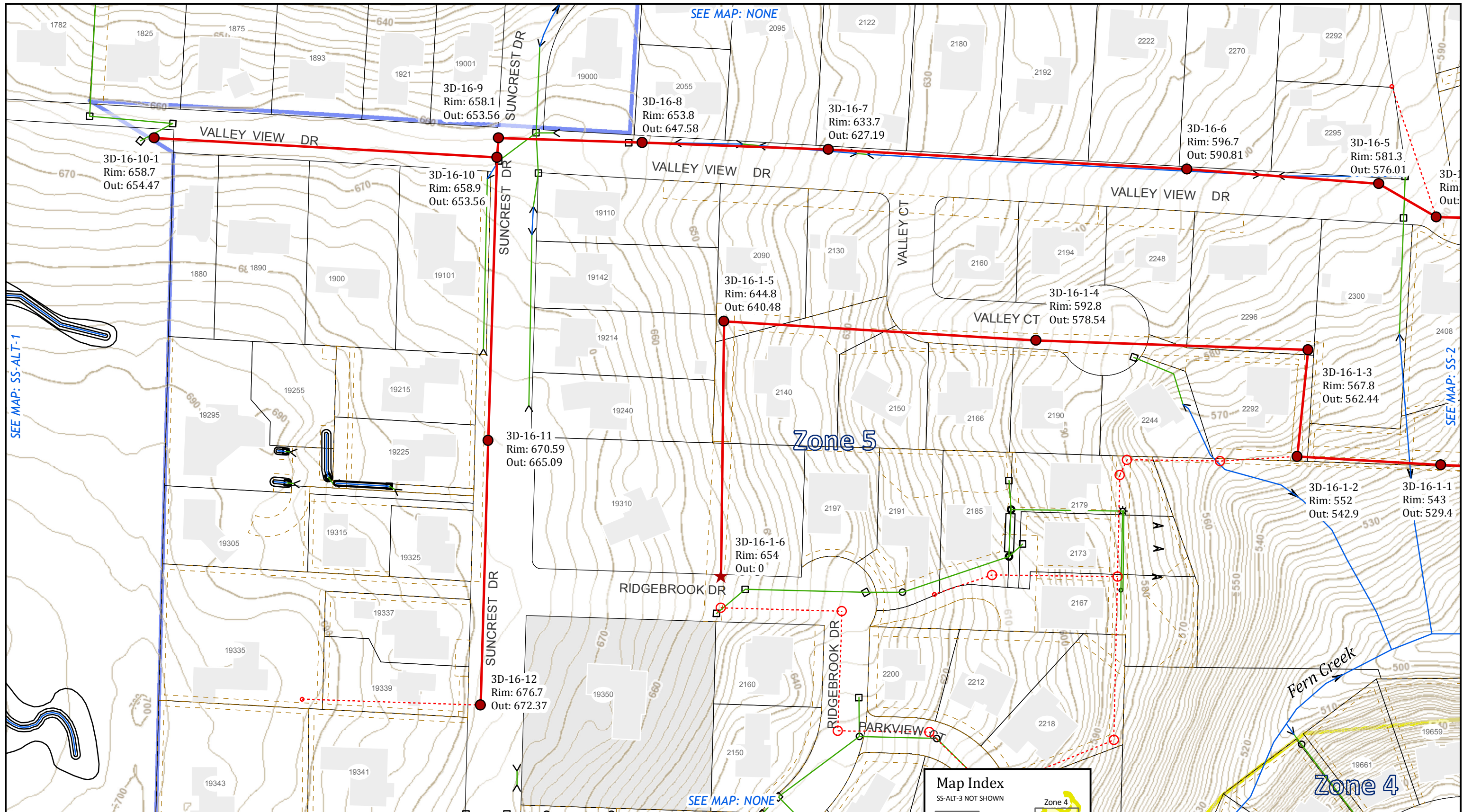

City of West Linn, Oregon
 Mapleton Sewer Rehabilitation Project
 Phase 3: Zones 4 and 5
 PW1214

Key Notes:
 A. CONTRACTOR TO INSTALL CIPP (CURED IN PLACE PIPE) LINER IN ALL OF THE SANITARY SEWER MAINS HIGHLIGHTED IN THE PLAN VIEW
 B. CONTRACTOR TO RECONNECT ALL ACTIVE LATERALS. CONTRACTOR TO CONFIRM STATUS OF LATERALS PRIOR TO INSTALLATION OF CIPP.
 C. CONTRACTOR TO REMOVE ALL PROTRUDING LATERALS AND ROOT INTRUSIONS PRIOR TO CIPP INSTALLATION.

- Manhole Inside Project Area
- ★ Clean Out Inside Project Area
- Sewer Mains Inside Project Area
- Condition Unknown (See Contract) Shown on maps SS-1, SS-2, and SS-3 only
- - - Other Sewer Mains
- Zone 4 Outline
- Zone 5 Outline
- Taxlot Lines & Address Numbers
- Buildings
- Known Easements
- 2-Foot Interval Contours
- Outside West Linn City Limits
- Storm Pipes
- Storm Open Channel

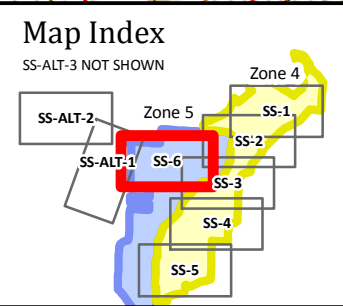

This product is for informational purposes and may not have been prepared for, or be suitable for legal, engineering, or surveying purposes. Users of this information should review or consult the primary data and information sources to ascertain the usability of the information.

1 Inch = 100 Feet

0 25 50 100 Feet

IF THIS BAR DOES NOT MEASURE 1" THEN THIS DRAWING IS NOT TO SCALE

SHEET
SS-6
 9 OF 12
 PUBLISHED 9/4/2012

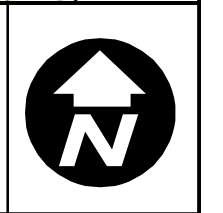

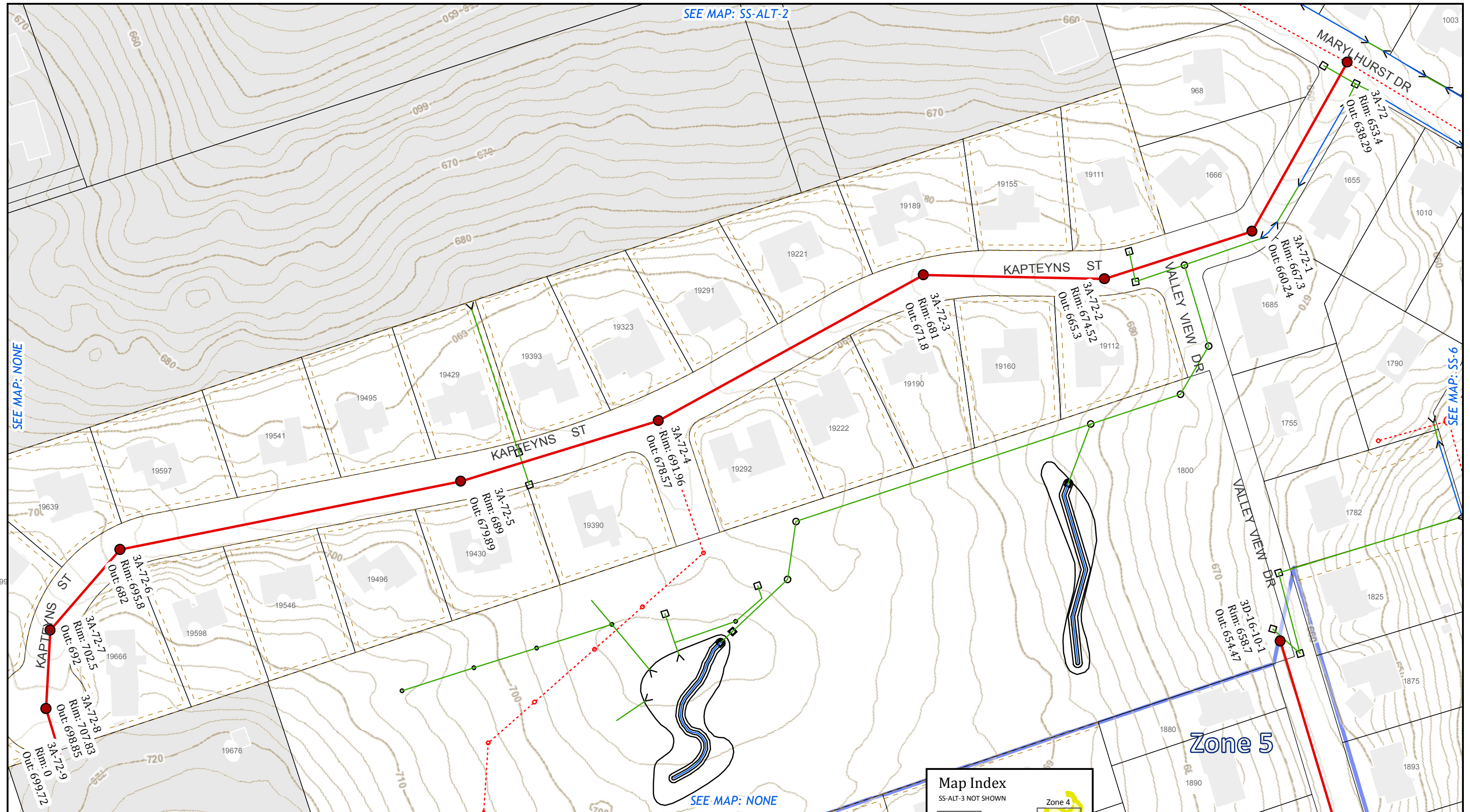

SEE MAP: NONE

SEE MAP: SS-ALT-2

SEE MAP: SS-6

SEE MAP: NONE



City of West Linn, Oregon
 Mapleton Sewer Rehabilitation Project
 Phase 3: Zones 4 and 5
 PW1214

Key Notes:
 A. CONTRACTOR TO INSTALL CIPP (CURED IN PLACE PIPE) LINER IN ALL OF THE SANITARY SEWER MAINS HIGHLIGHTED IN THE PLAN VIEW
 B. CONTRACTOR TO RECONNECT ALL ACTIVE LATERALS. CONTRACTOR TO CONFIRM STATUS OF LATERALS PRIOR TO INSTALLATION OF CIPP.
 C. CONTRACTOR TO REMOVE ALL PROTRUDING LATERALS AND ROOT INTRUSIONS PRIOR TO CIPP INSTALLATION.

- Manhole Inside Project Area
- ★ Clean Out Inside Project Area
- Sewer Mains Inside Project Area
- Condition Unknown (See Contract) Shown on maps SS-1, SS-2, and SS-3 only
- - - Other Sewer Mains
- Zone 4 Outline
- Zone 5 Outline
- Taxlot Lines & Address Numbers
- Buildings
- Known Easements
- 2-Foot Interval Contours
- Outside West Linn City Limits
- Storm Pipes
- Storm Open Channel

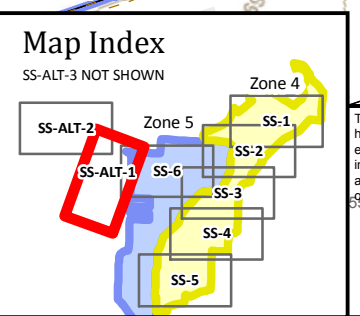

This product is for informational purposes and may not have been prepared for, or be suitable for legal, engineering, or surveying purposes. Users of this information should review or consult the primary data and information sources to ascertain the usability of the information.

1 Inch = 100 Feet

0 25 50 100 Feet

IF THIS BAR DOES NOT MEASURE 1" THEN THIS DRAWING IS NOT TO SCALE

SHEET
SS-ALT-1
 10 OF 12
 PUBLISHED 9/4/2012

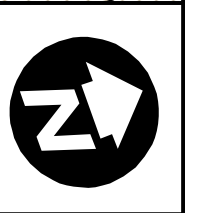

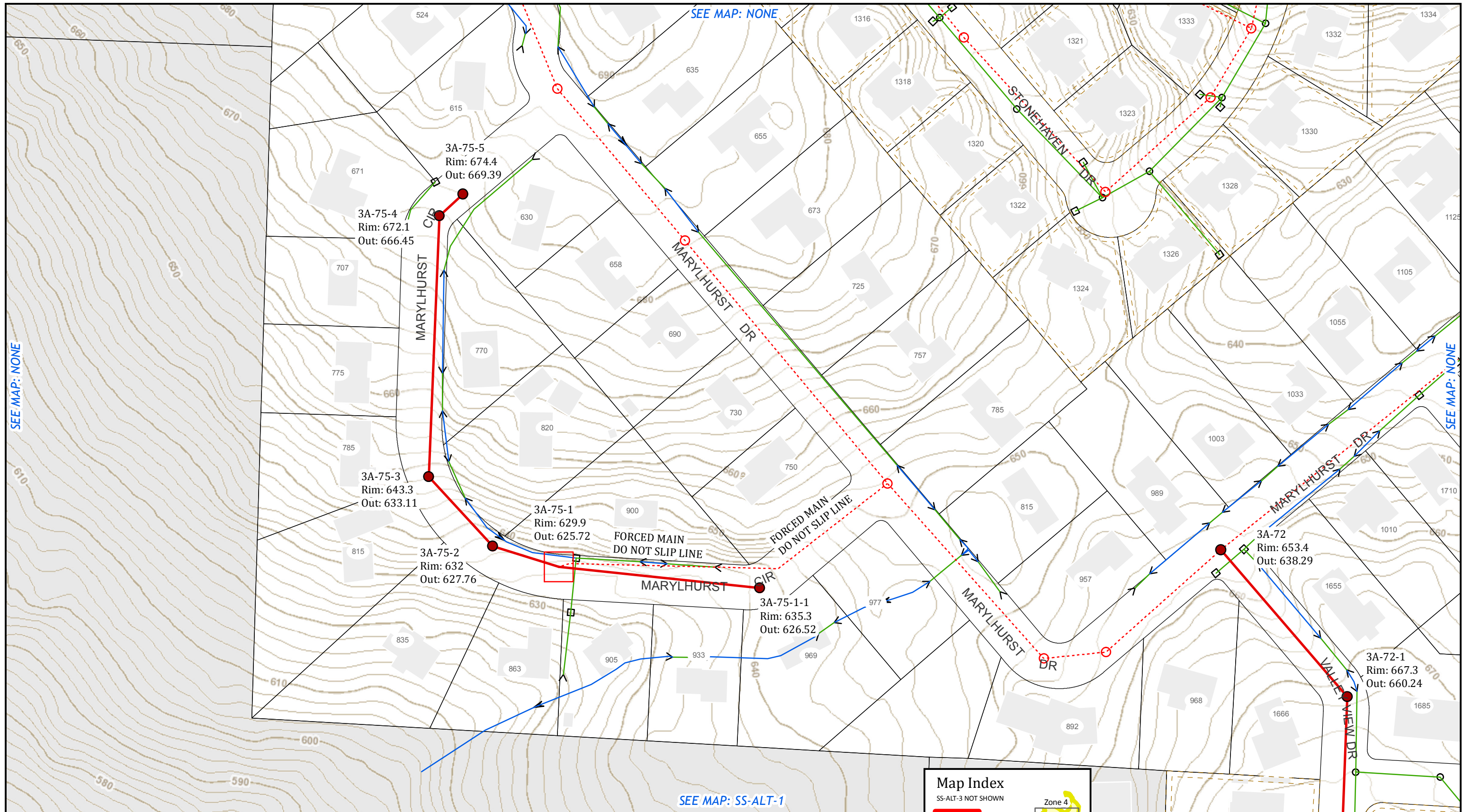

City of West Linn, Oregon
 Mapleton Sewer Rehabilitation Project
 Phase 3: Zones 4 and 5
 PW1214

Key Notes:
 A. CONTRACTOR TO INSTALL CIPP (CURED IN PLACE PIPE) LINER IN ALL OF THE SANITARY SEWER MAINS HIGHLIGHTED IN THE PLAN VIEW
 B. CONTRACTOR TO RECONNECT ALL ACTIVE LATERALS. CONTRACTOR TO CONFIRM STATUS OF LATERALS PRIOR TO INSTALLATION OF CIPP.
 C. CONTRACTOR TO REMOVE ALL PROTRUDING LATERALS AND ROOT INTRUSIONS PRIOR TO CIPP INSTALLATION.

- Manhole Inside Project Area
 - ★ Clean Out Inside Project Area
 - Sewer Mains Inside Project Area
 - Condition Unknown (See Contract) Shown on maps SS-1, SS-2, and SS-3 only
 - - - Other Sewer Mains
 - Zone 4 Outline
 - Zone 5 Outline
 - Taxlot Lines & Address Numbers
 - Buildings
 - Known Easements
 - 2-Foot Interval Contours
 - Outside West Linn City Limits
 - Storm Pipes
 - Storm Open Channel
- Taxlot Base Source: Clackamas County, Utility Map Overlays: West Linn GIS

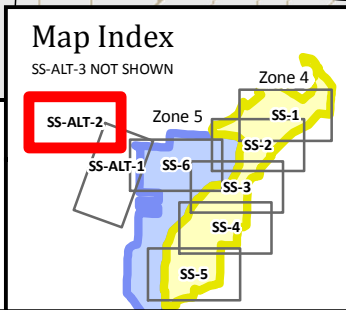

This product is for informational purposes and may not have been prepared for, or be suitable for legal, engineering, or surveying purposes. Users of this information should review or consult the primary data and information sources to ascertain the usability of the information.

1 Inch = 100 Feet

0 25 50 100 Feet

IF THIS BAR DOES NOT MEASURE 1" THEN THIS DRAWING IS NOT TO SCALE

SHEET
SS-ALT-2
 11 OF 12
 PUBLISHED 9/4/2012

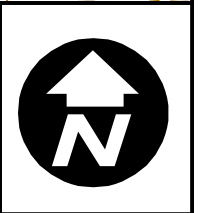

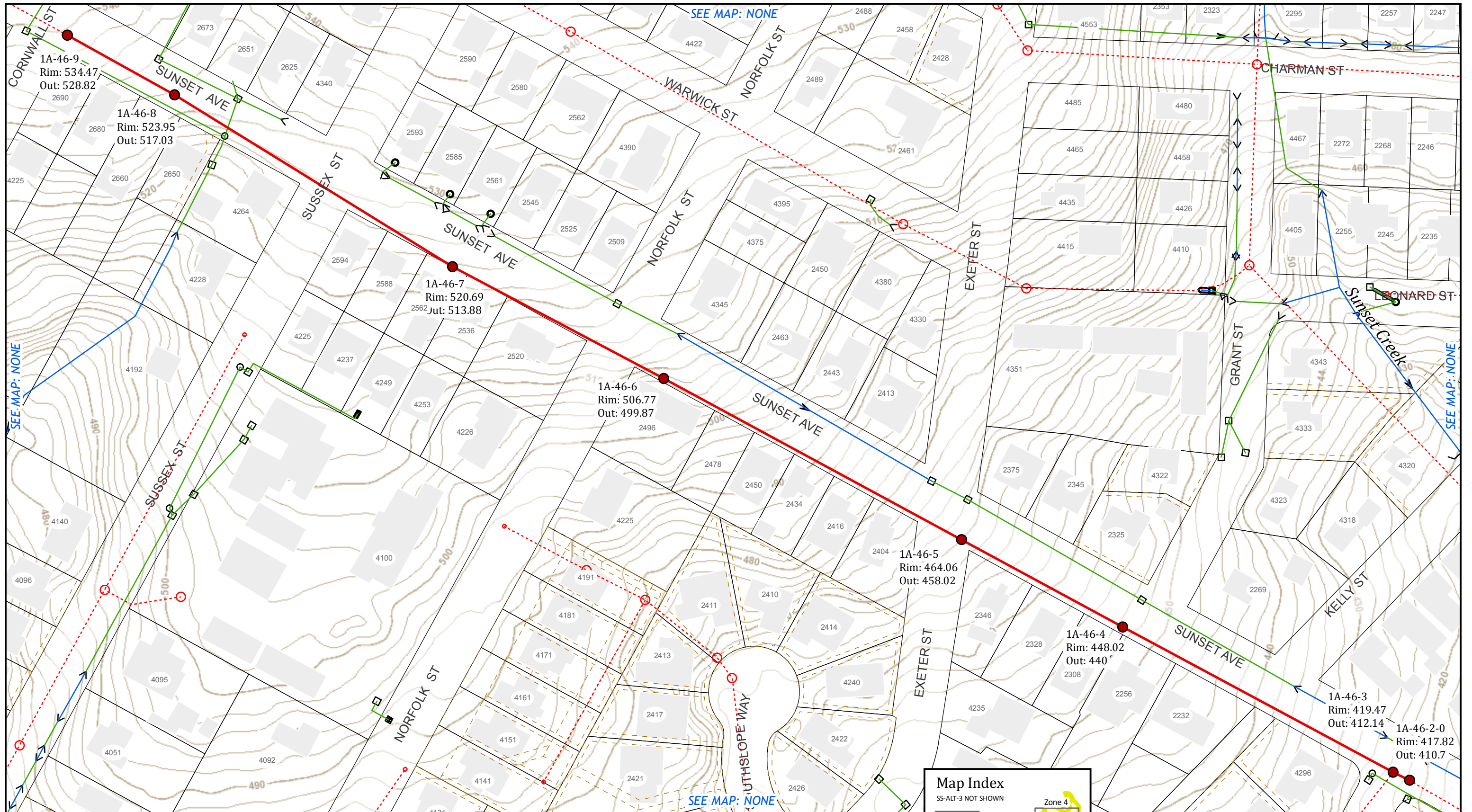

City of West Linn, Oregon
 Mapleton Sewer Rehabilitation Project
 Phase 3: Zones 4 and 5
 PW1214

Key Notes:
 A. CONTRACTOR TO INSTALL CIPP (CURED IN PLACE PIPE) LINER IN ALL OF THE SANITARY SEWER MAINS HIGHLIGHTED IN THE PLAN VIEW
 B. CONTRACTOR TO RECONNECT ALL ACTIVE LATERALS. CONTRACTOR TO CONFIRM STATUS OF LATERALS PRIOR TO INSTALLATION OF CIPP.
 C. CONTRACTOR TO REMOVE ALL PROTRUDING LATERALS AND ROOT INTRUSIONS PRIOR TO CIPP INSTALLATION.

- Manhole Inside Project Area
- ★ Clean Out Inside Project Area
- Sewer Mains Inside Project Area
- Condition Unknown (See Contract) Shown on maps SS-1, SS-2, and SS-3 only
- - - Other Sewer Mains
- Zone 4 Outline
- Zone 5 Outline
- Taxlot Lines & Address Numbers
- Buildings
- Known Easements
- 2-Foot Interval Contours
- Outside West Linn City Limits
- Taxlot Base Source: Clackamas County, Utility Map Overlays: West Linn GIS
- Storm Pipes
- Storm Open Channel

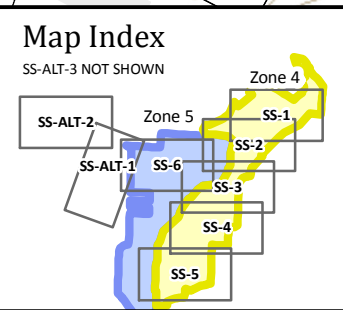

This product is for informational purposes and may not have been prepared for, or be suitable for legal, engineering, or surveying purposes. Users of this information should review or consult the primary data and information sources to ascertain the usability of the information.

1 Inch = 100 Feet

IF THIS BAR DOES NOT MEASURE 1" THEN THIS DRAWING IS NOT TO SCALE

SHEET
SS-ALT-3
 12 OF 12
 PUBLISHED 9/4/2012

