



LAND USE PRE-APPLICATION CONFERENCE

Thursday, September 1, 2011

City Hall
22500 Salamo Road

Willamette Conference Room

1:30 pm Build a section of ADA accessible trail to interpretive site at Oak Savanna and more challenging loop trail that explores the upper parts of the site

Applicant: City of West Linn Parks Department, Mike Perkins

Subject Property Address: 2425 Tannler Dr.

Neighborhood Assn: Savanna Oaks & Willamette

Planner: Tom Soppe

Project #: PA-11-21

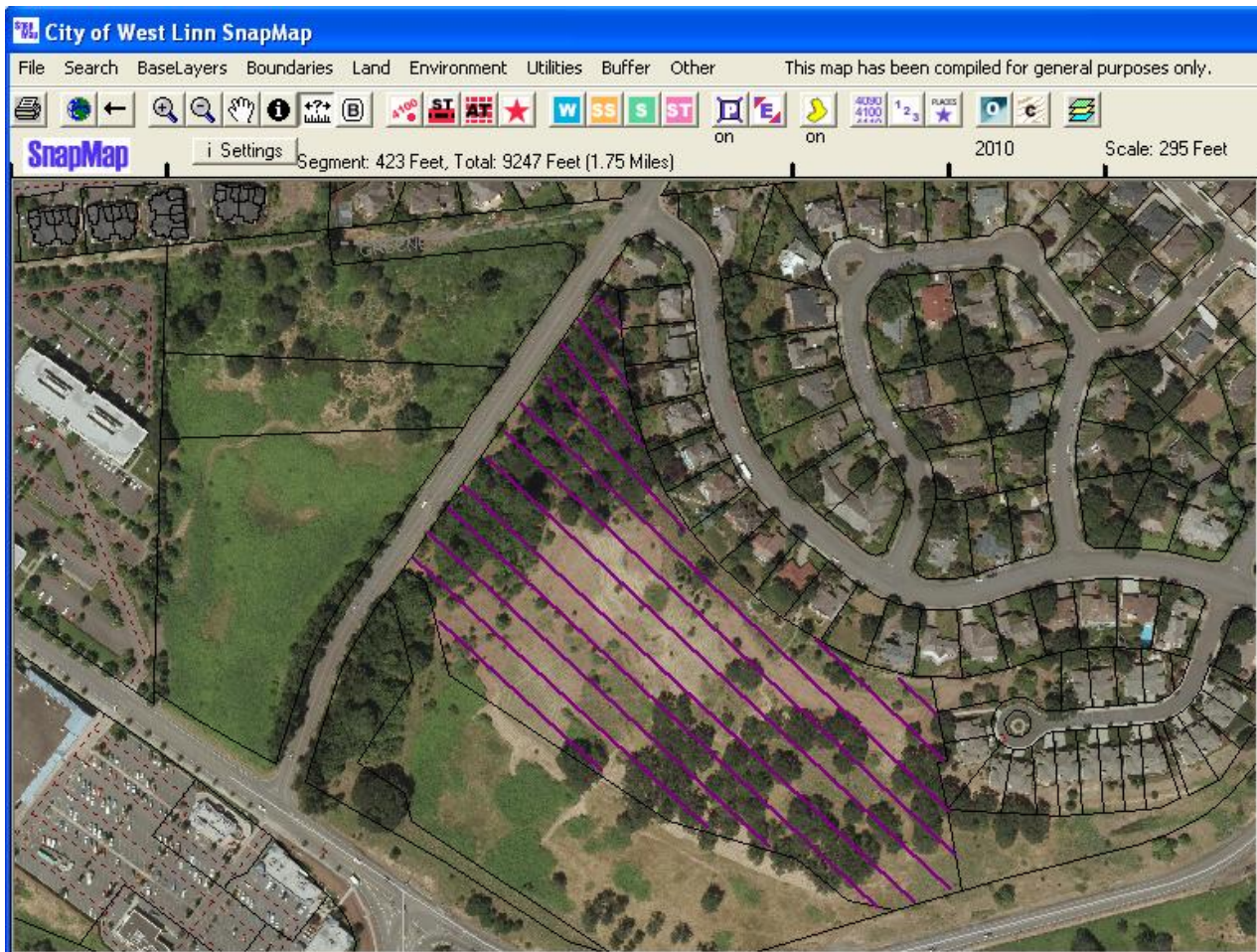



PRE-APPLICATION CONFERENCE

THIS SECTION FOR STAFF COMPLETION		
CONFERENCE DATE: <u>9/1/11</u>	TIME: 10:30 AM <u>1:30 PM</u>	PROJECT #: <u>PA-11-21</u>
STAFF CONTACT:		FEE: <u>0</u>

Pre-application conferences occur on the first and third Thursdays of each month. In order to be scheduled for a conference, this form including property owner's signature, the pre-application fee, and accompanying materials must be submitted at least 14 days in advance of the conference date. Twenty-four hour notice is required to reschedule.

Address of Subject Property (or map/tax lot): 2425 TAWLER DR. (OAK SAVANNAH)

Brief Description of Proposal: BUILD A SECTION OF ADA ACCESSIBLE TRAIL TO INTERPRETIVE SITE @ OAK SAVANNAH & MORE CHALLENGING LOOP TRAIL THAT EXPLORES THE UPPER PARTS OF THE SITE

Applicant's Name: CITY OF W.L. PARKS DEPT.

Mailing Address: _____

Phone No: (503) 557-4700 Email Address: _____

Please attach additional materials relating to your proposal including a site plan on paper up to 11 x 17 inches in size depicting the following items:

- North arrow
- Scale
- Property dimensions
- Streets abutting the property
- Conceptual layout, design and/or building elevations
- Access to and from the site, if applicable
- General location of existing trees
- Location of creeks and/or wetlands
- Location of existing utilities (water, sewer, etc.)
- Easements (access, utility, all others)

Please list any questions or issues that you may have for city staff regarding your proposal:

By my signature below, I grant city staff right of entry onto the subject property in order to prepare for the pre-application conference.

Property owner's signature

8-9-11
Date

Property owner's mailing address (if different from above) _____