

THIS IS PLAN SET FROM WEST LINN ENGINEERING. PER ERICH L 2/10/2017 WILL CONTACT CONTRACTOR FOR RED LINE OR ASBUILT DRAWING SET

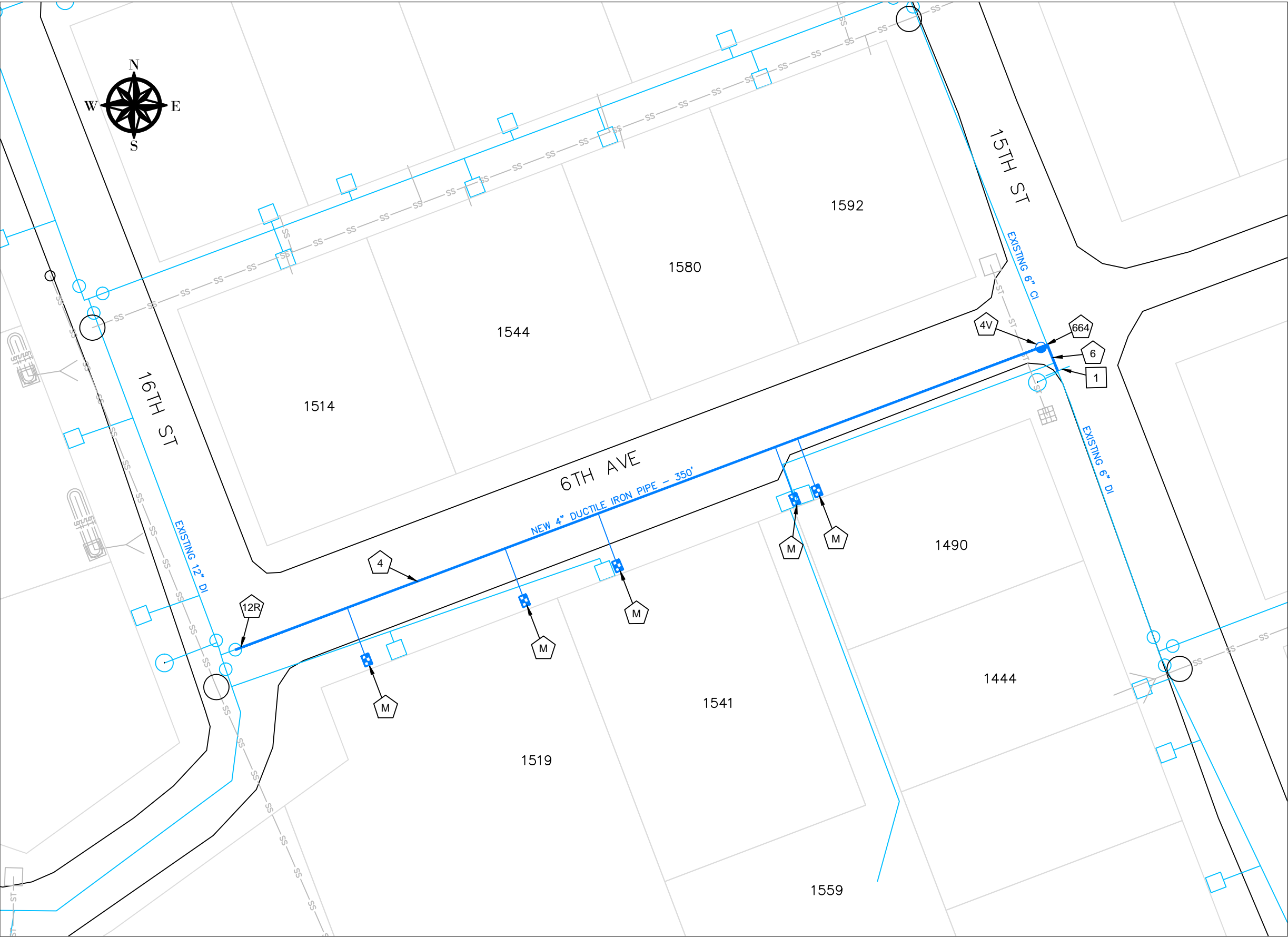

GENERAL CONSTRUCTION NOTE
WATER METER LOCATIONS TO BE
DETERMINED IN FIELD BY CITY OF WEST LINN
PRIOR TO CONSTRUCTION.

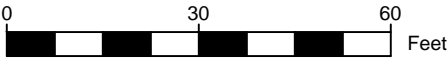

CITY OF
West Linn
CITY OF WEST LINN
22500 SALAMO ROAD
WEST LINN, OREGON 97068
WWW.WESTLINNOREGON.GOV
PHONE: (503) 722-5500
FAX: (503) 656-4106

CONTRACTOR

NAME:
ADDRESS:

PHONE:
FAX:

CONSTRUCTION NOTES

NO	DESCRIPTION	UNIT	QTY
M	NEW METER & BOX PER WL-DETAIL 402.	EA	5
4	4 INCH DUCTILE IRON PIPE, FITTINGS & COUPLINGS W/ RESTRAINED JOINTS AND CLASS B BACKFILL	LF	350
6	6 INCH DUCTILE IRON PIPE, FITTINGS & COUPLINGS W/ RESTRAINED JOINTS AND CLASS B BACKFILL	LF	10
4V	4 INCH GATE VALVE	EA	1
664	6"x6"x4" TEE, FLG, CONNECTION TO EXISTING 6" CI MAIN	EA	1
12R	12"x4" REDUCER	EA	1
1	GENERAL CONSTRUCTION NOTES CAST IRON TO DUCTILE CONNECTION DRAWN PER 2003 WILLAMETTE NEIGHBORHOOD UTILITY REPLACEMENT PHASE-1 AS-BUILT DRAWING. FIELD VERIFY ACTUAL LOCATION MAY VARY.		

CITY OF WEST LINN
WATERLINE

6TH AVE FROM 15TH ST TO 16TH ST

REVISION

DATE	DESCRIPTION

PROJECT NO.:
DESIGNED BY: ELAIS
DRAWN BY: NBRENNAN

CHECKED BY: ELAIS
DATE: 11/21/2014

SITE PLAN

SCALE: 1" = 50' Horizontal

A1